

# VASART®

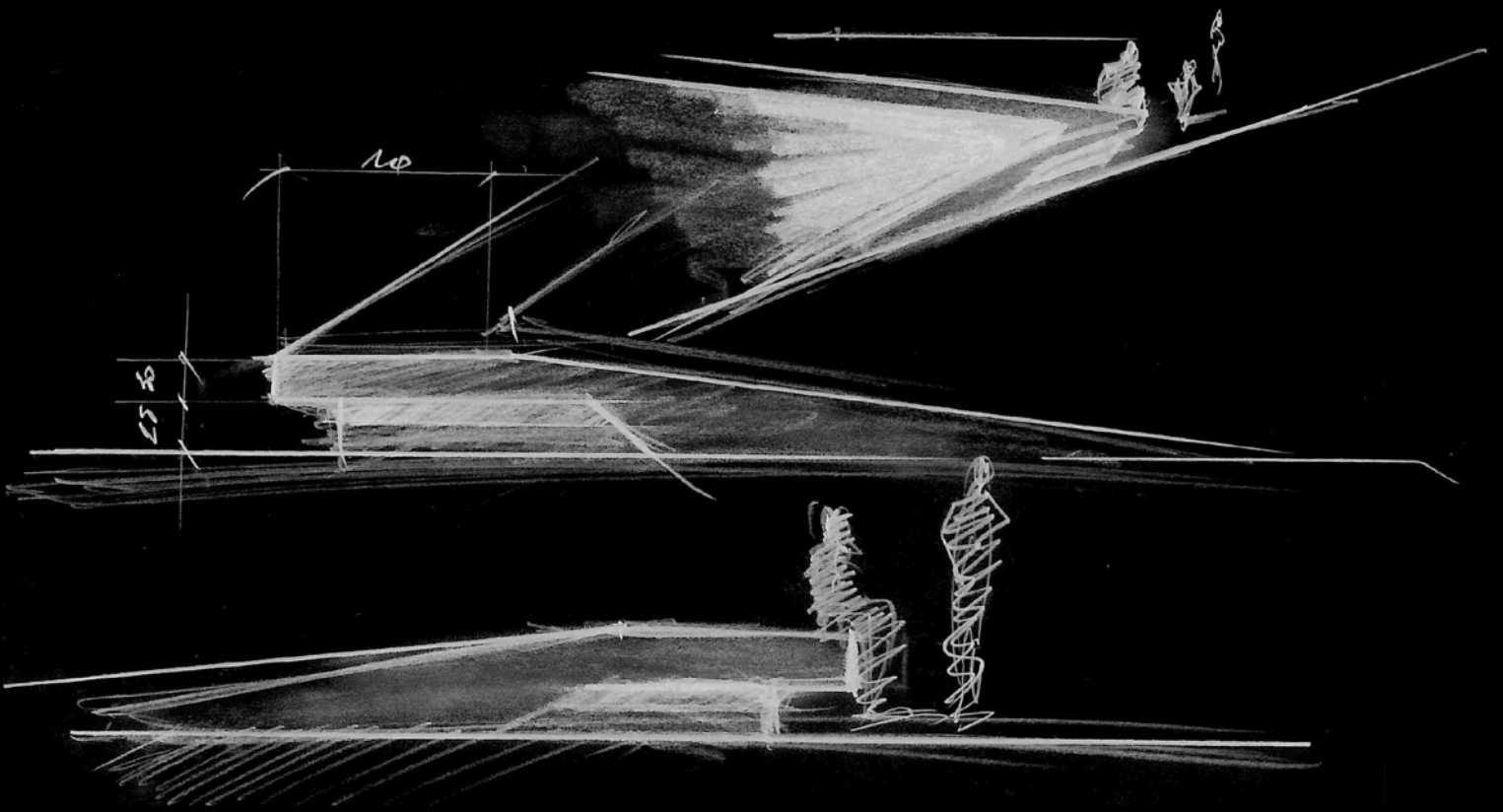

| URBAN FURNITURE ATELIER |



## TWO BROTHERS, ONE STORY.

Relations between brothers do not follow precise rules; they follow the waves of life. We unite and disunite, we distance ourselves and we get closer again.

We navigate by sight.

But what has always tied us in the end is the passion for our work (transmitted by our parents).

Together we have sailed in calm waters and together we have faced storms (and it is exactly the difficult moments that create the strongest bonds...).

Today we are proud to be the “captains” of a wonderful team that still needs and wants to win a lot.

*Andrea and Tiziano Gozzi.*



## URBAN FURNITURE... THE BUSINESS CARD OF A CITY.

It is a principle that applies to all Municipalities, from the smallest to the largest metropolis, with the obvious differences.

URBAN FURNITURE must identify a city, a square, a seafront, a place... telling the story, taking into account an identity or “simply” making us dream, combining aesthetics, beauty and functionality. Urban furniture must express different identities, by history, culture, vocation.

We can also speak of urban furniture as a tool capable of developing the civic sense of citizens.

“The beautiful” recalls more polite behaviors and the sense of order increases the civic sense.

Urban furniture must and can induce virtuous behaviour.

The catalogue you are about to browse through is a collection of meetings, dialogues, exchange of knowledge, site visits, sketches, drafts, technical drawings, specifications... which have become **PROJECTS, REALIZATIONS, LINKS..**

**THE ARTISTIC SIDE  
OF URBAN  
FURNITURE.**

*In urban furniture, in my opinion, artistic intervention is fundamental. This requires a work of integration between architect and sculptor”.*

(Arnaldo Pomodoro)

With the utmost humility we are those artisans, somehow artists, who are capable of creating the shapes you have dreamed of, thought of, designed... creating high quality urban furniture elements.





## 01 RICCIONE p. 11-47

GOETHE AND SHAKESPEARE WALK RESTYLING

- Fountain (Shelter | Basin | Bench) p. 14
- Shading Leaf Structure and Light Point p. 20
- Curved and straight Metropolitan seat p. 26
- Backless Cover seat p. 34
- Backrest Cover seat p. 38
- Single Relax seat p. 40
- Nuvola small planter p. 44
- Nuvola medium seat and Nuvola pouf p. 46

## 02 SAVONA p. 49-59

GIARDINO DEGLI AGRUMI - FORTEZZA PRIAMAR

- Living Lab: Multifunctional isle p. 52
- Planter p. 56

## 03 PARMA p. 61-73

PIAZZALE PABLO

- Ducale Bench p. 62
- Pablo Bench p. 68

## 04 MILANO p. 75-85

PIAZZA FERNANDA PIVANO

- Planter p. 76
- Benches p. 78

## 05 VARIGOTTI p. 87-101

PASSEGGIATA LUNGOMARE

- Stainless steel Cube planter p. 90
- Cover bench with backrest and top p. 94
- Gate barrier p. 96
- Lungomare bench p. 98

## 06 BELLARIA p. 103-117

PASSEGGIATA LUNGOMARE

- Cordolo Sand Seat p. 104
- Tree grate p. 108
- Rock seat with and without backrest p. 110

## 07 SAN MAURO MARE p. 119-127

WATERFRONT

- Cordolo Sand Seat p. 120

## 08 REGGIO EMILIA p. 129-135

PIAZZA GIOBERTI

- Fountain p. 130

## 09 PIETRA LIGURE p. 137-143

PIAZZA VITTORIO EMANUELE

- Split Bench p. 138

## 10 CATTOLICA p. 145-165

LUNGOMARE RASI SPINELLI

- Promenade range bench p. 146
- Backless modular bench p. 160

## 11 SALUDECIO p. 167-173

PIAZZA SANTO AMATO RONCONI

- Station bench p. 169
- Nuvola planter p. 169
- Nuvola seat p. 170

## 12 MARINA DI OLBIA p. 175-183

TOURIST PORT

- Mediterranea range p. 177
- Barrier p. 182

## 13 RICCIONE p. 185-191

CORSO FRATELLI CERVI

- Layer backrest seat p. 186

## 14 MONTE ARGENTARIO p. 193-225

PORTO SANTO STEFANO e PORTO ERCOLE

- Dialogo range p. 194
- Modular seat p. 196
- Dialogo small bench p. 198
- Dialogo maxi bench p. 204
- Nuvola planter p. 210
- Dialogo & Incontro bench p. 216

## 15 FALCONARA MARITTIMA p. 227-233

Metropolitan bench with and without backrest p. 228

## 16 FIUMICINO p. 235-243

LEONARDO DA VINCI AIRPORT

- Dune bench p. 236

## BEYOND SHAPES p. 272-275

## ABSTRACT

Openfabric and Vasart Urban Design collaboration

## BEYOND DESIGN p. 276-277

## 17 QATAR p. 245-253

DOHA

- Various projects p. 246

## 18 CIVITAVECCHIA p. 255-263

TERRAZZA GUGLIELMI

- Station bench with and without backrest p. 256

## 19 POST PANDEMIC BENCH

PARMA

- Bench/Planter p. 265-271

Bench/Planter

p. 266



**PROJECT | RICCIONE**

| GOETHE AND SHAKESPEARE WALK RESTYLING |

01

## THE PROJECT

The restyling of Lungomare Goethe in Riccione is a very successful redevelopment of the northern area between Piazzale Azzarita and the bridge over the Rio Marano.

The new Lungomare is exclusively pedestrian and has small squares, fountains and verdant flowerbeds, very close to the sea. Today it is possible to walk for about 1,300 meters among the fresh scent of greenery, the elegant white design of furnishings and structures, and the colors of the many flowers that brighten up the beautiful flowerbeds.



## RICCIONE

### GOETHE AND SHAKESPEARE WALK RESTYLING

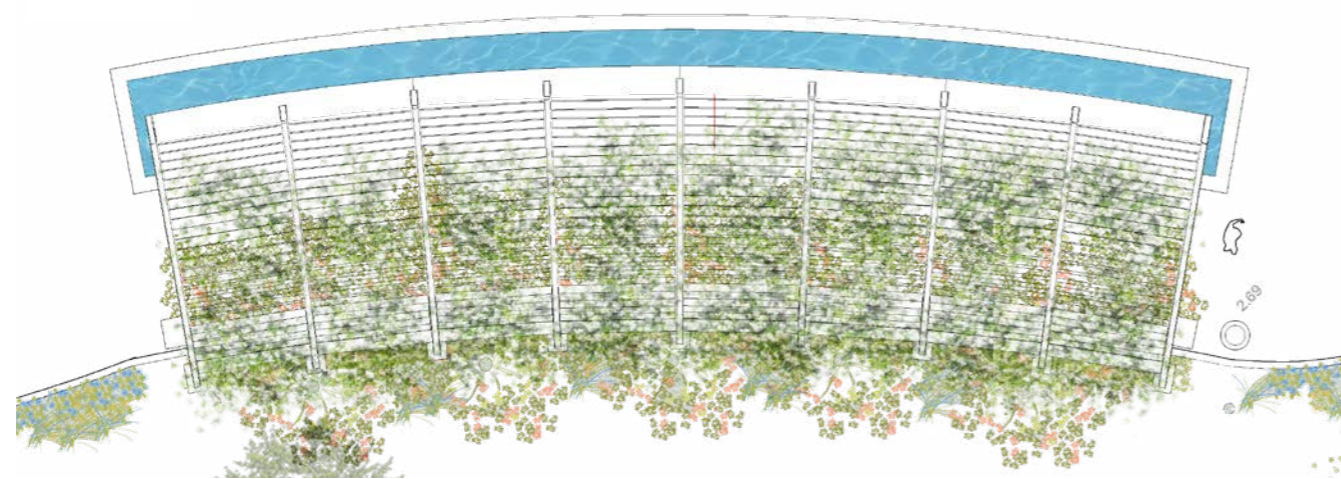

#### Sophisticated Design

The elegant furnishings with a refined but at the same time functional design (the music wafts from the benches and the leaves are shading by day and lit by LEDs at night-time), are the characteristic elements of a successful work that gives further style to the city, in an innovative way.

- Preliminary project: Technical Office of the Municipality of Riccione
- Executive project : POLISTUDIO A.E.S. (Architectural design Arch. Pietro Marsciani)
- Works Management: Geom. Augusto Frisoni and Arch. Giovanni Morri (Municipality of Riccione)
- Supervision on architectural choices: Renata Tosi and Arch. Lea Ermeti
- Executing companies: LUCOS (Surveyor Orazio Del Prete) – CBR
- Metal structure made by “Carpenteria Battistini”

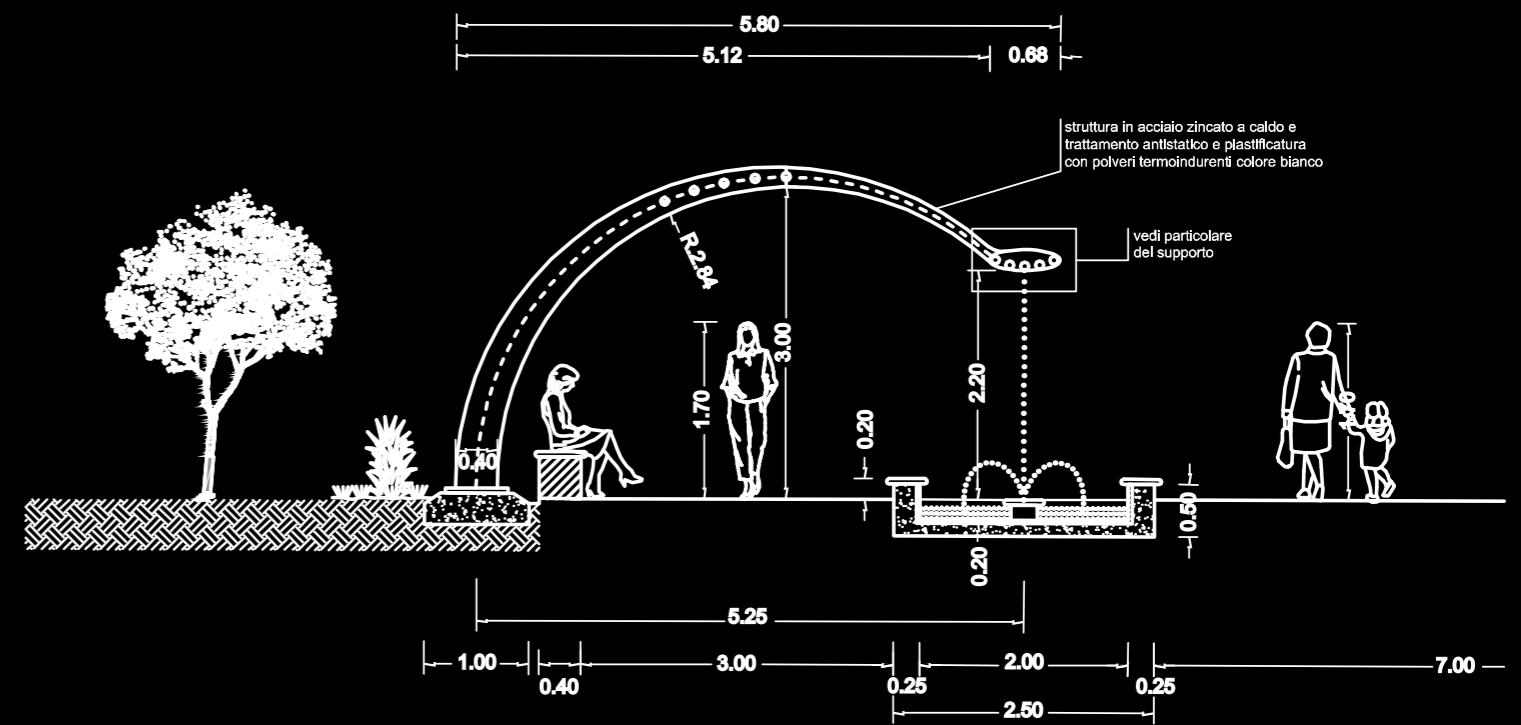

#### UNIQUE ELEMENTS

A pleasant linearity is perceived between materials and natural colors, between soft and irregular shapes. The fountain that lights up its colors on the waterfall has become a real night-time attraction.



## THE FOUNTAIN

is composed by:

- An imposing metal shelter that works as a shade and as a fountain (from here the cascade of water descends and the color lights are installed).
- The basin of the fountain, with the perimeter edges covered in honed Carrara white high-performance concrete.
- The seat with a length of 21 linear meters is made on site in VUD01 smoothed Carrara white high-performance concrete; complete with seats in wood-effect wpc slats, led lighting and sound system.





## CREATING a magical atmosphere

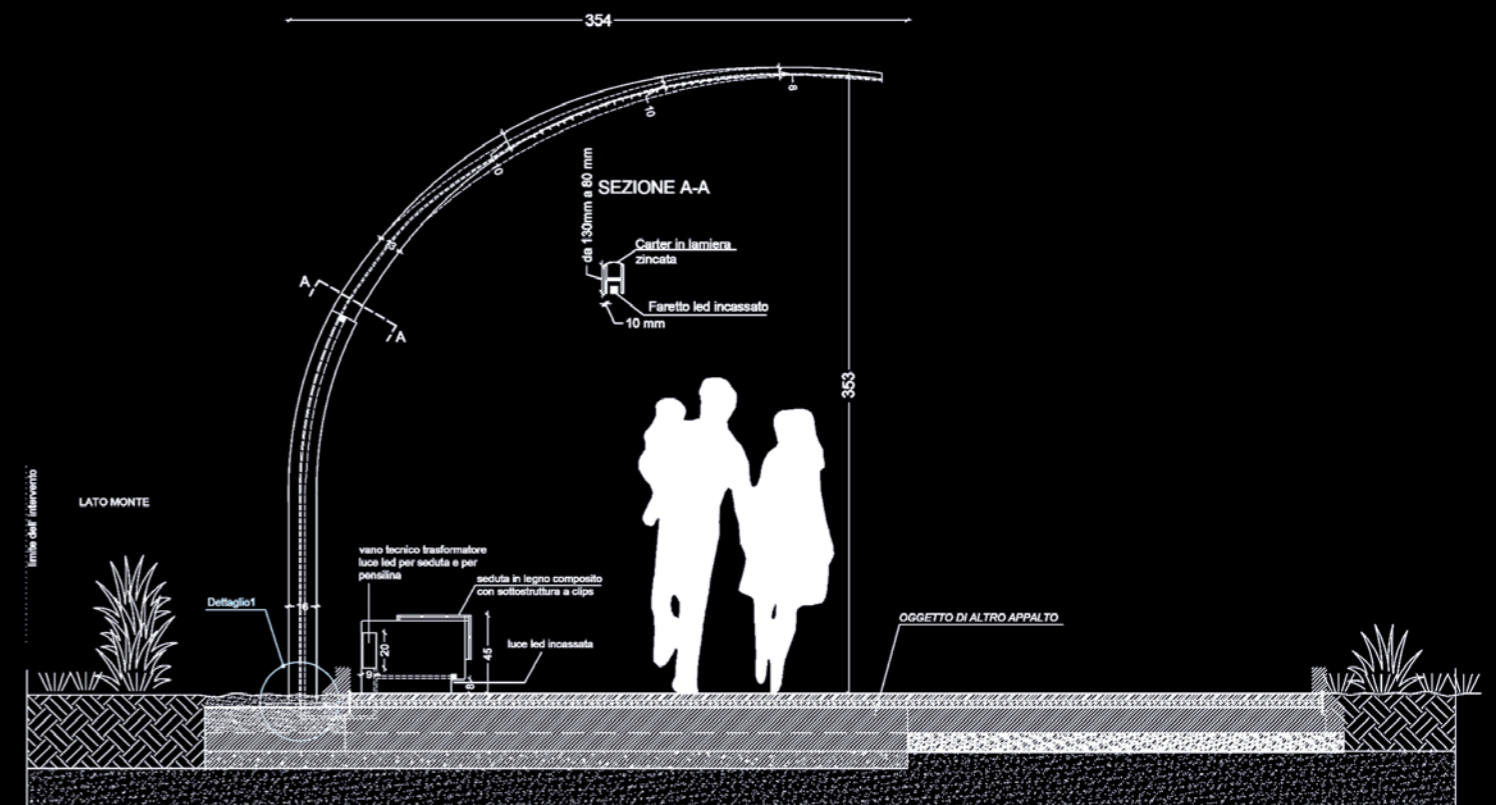
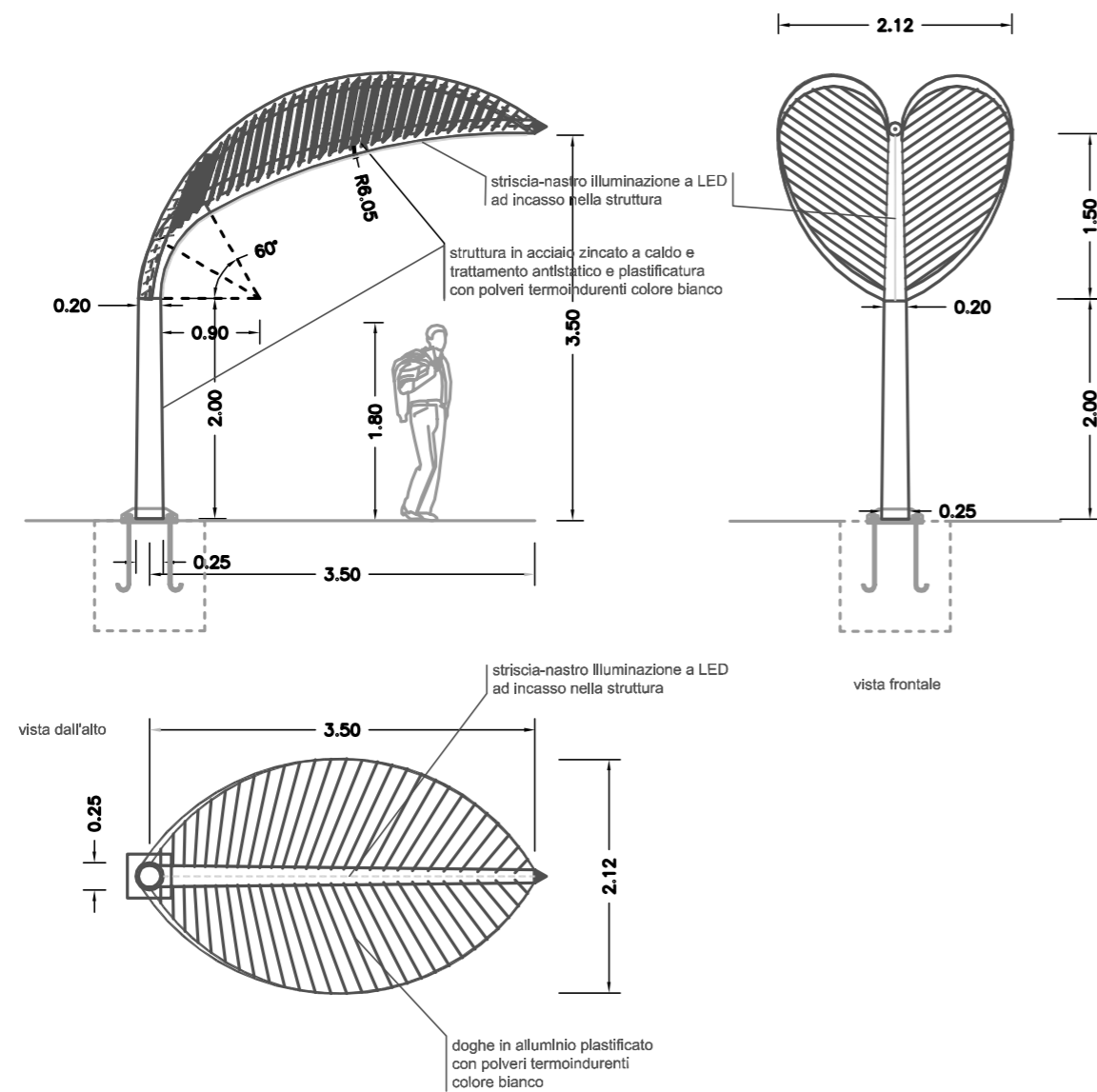

PROSPETTO FOGLIA  
SCALA 1:20

## LEAF STRUCTURE

These elements are made of hot galvanized and painted steel. They provide shade during the day and light up in the evening, creating a magical atmosphere.





## LED ILLUMINATION

and sound diffusion system...  
more than a simple seat



## CURVED and STRAIGHT METROPOLITAN SEAT

The Metropolitan seats can be both linear and curved, with three different bend radius. They are made of completely smoothed and anti-graffiti treated VUD01 Carrara white high-performance concrete; they are always equipped with flat seats made of high quality wpc slats and AISI 304 stainless steel frame, LED lighting and a sound diffusion system located inside the bench.

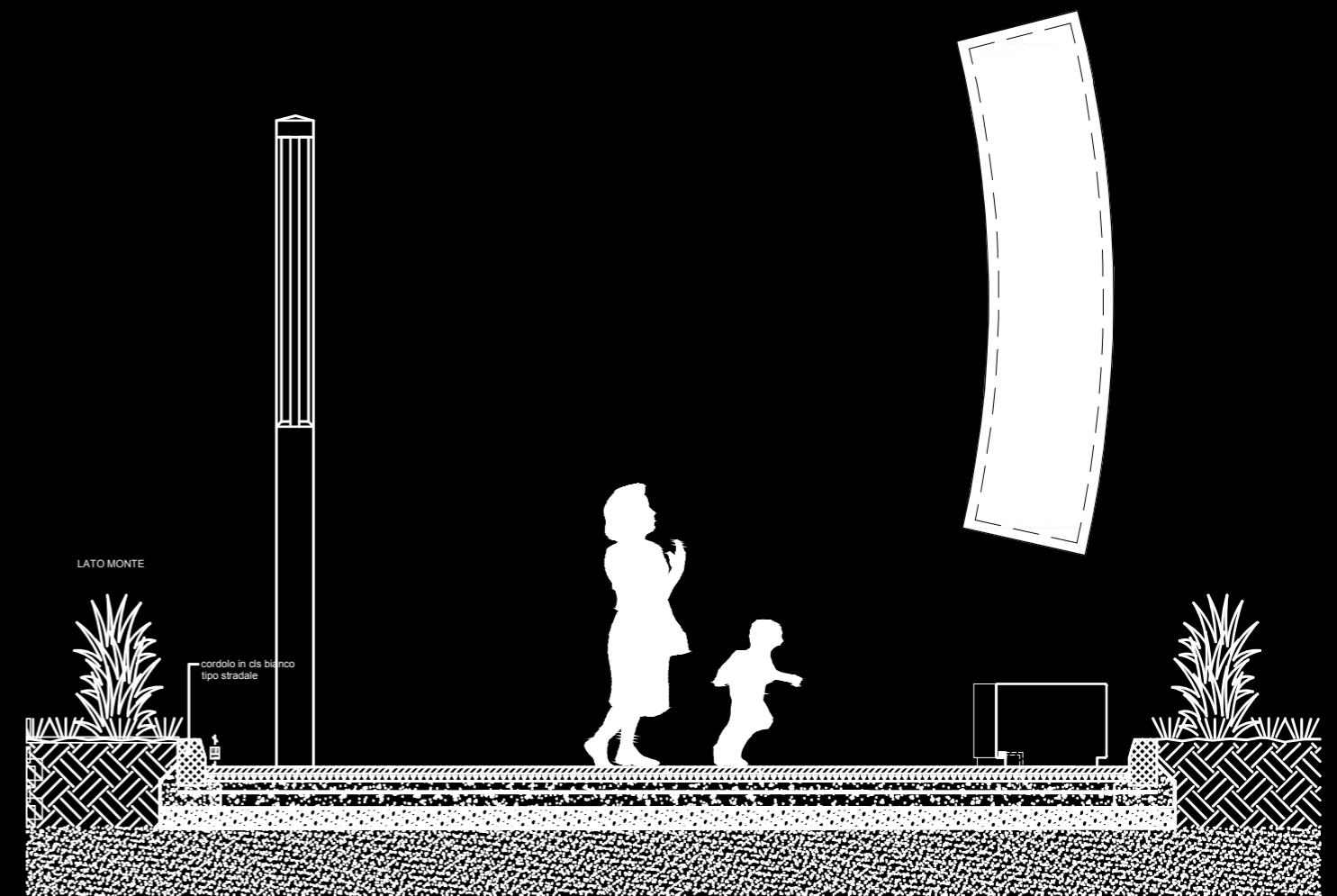

CURVED and STRAIGHT METROPOLITAN









## LIGHTNESS

of the lines and quality of the materials

The Cover seats on the wall divide the area of the Lungomare promenade from the seaside.

They are made of completely smoothed and anti-graffiti treated VUD01 Carrara white high-performance concrete; they are equipped with flat seats or with backrests, made of high quality wpc slats, with a wood effect and AISI 304 stainless steel frame, LED lighting and a sound diffusion system located inside the bench.

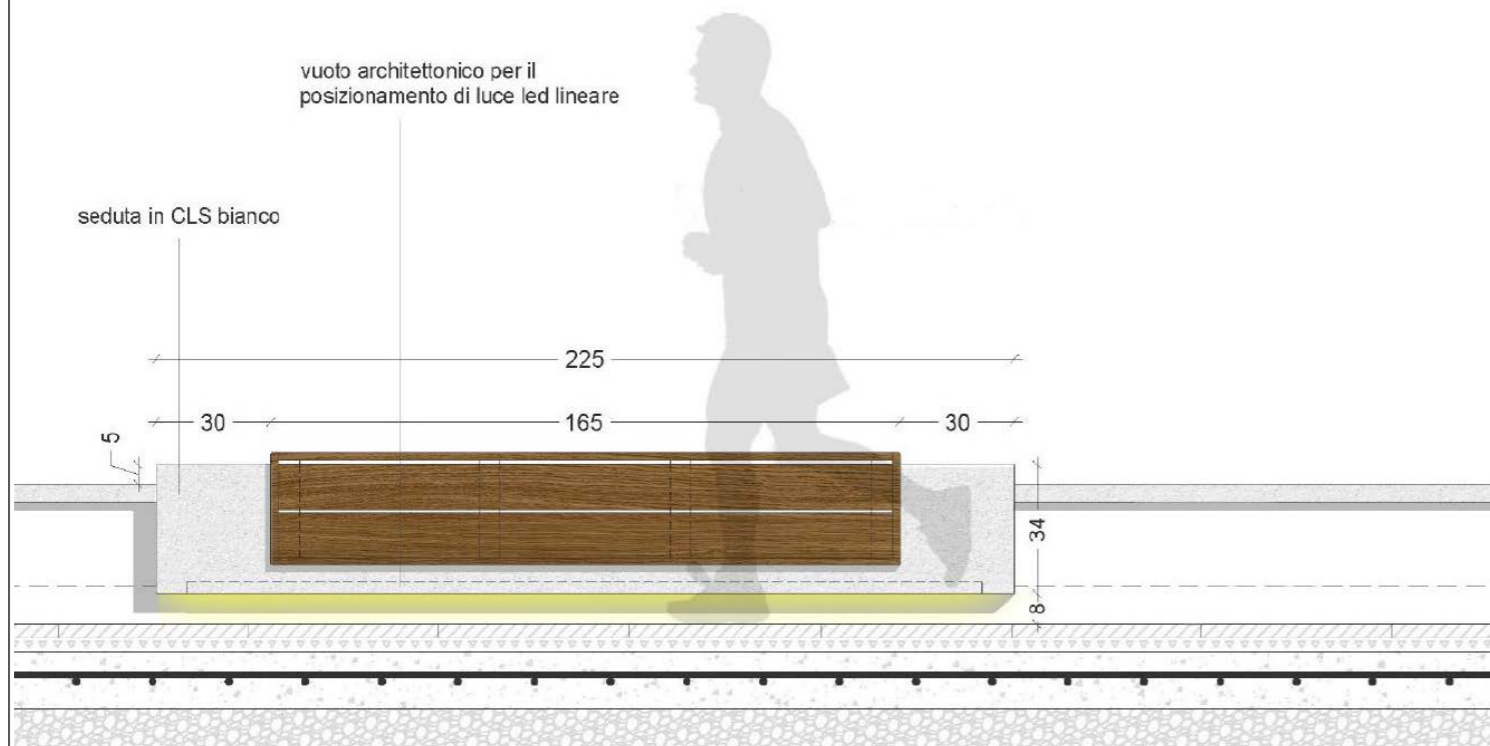



## A SIMPLE and INNOVATIVE DESIGN

gives style to the waterfront

The Cover seats can be adapted to existing walls or can be positioned independently with self-supporting modules.

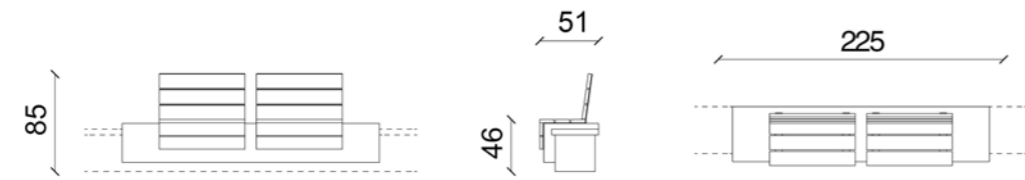

BACKREST COVER SEATS

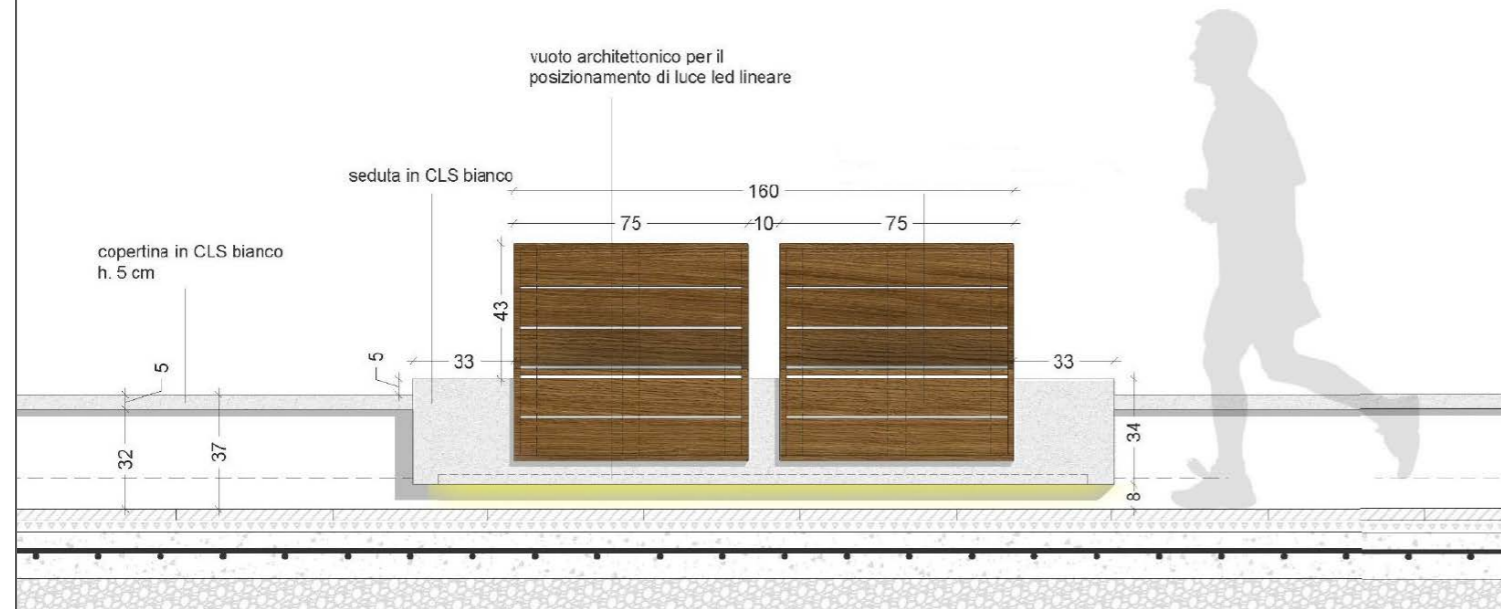

## WALKING and... relaxing

Relax single seats, composed of a base made of VUD01 high-performance concrete in completely smoothed and anti-graffiti treated white Carrara color, and of an inclined seat (Relax in fact) made of high quality wpc slats with a wood effect and frame in electropolished AISI 304 stainless steel.

RELAX SINGLE SEATS

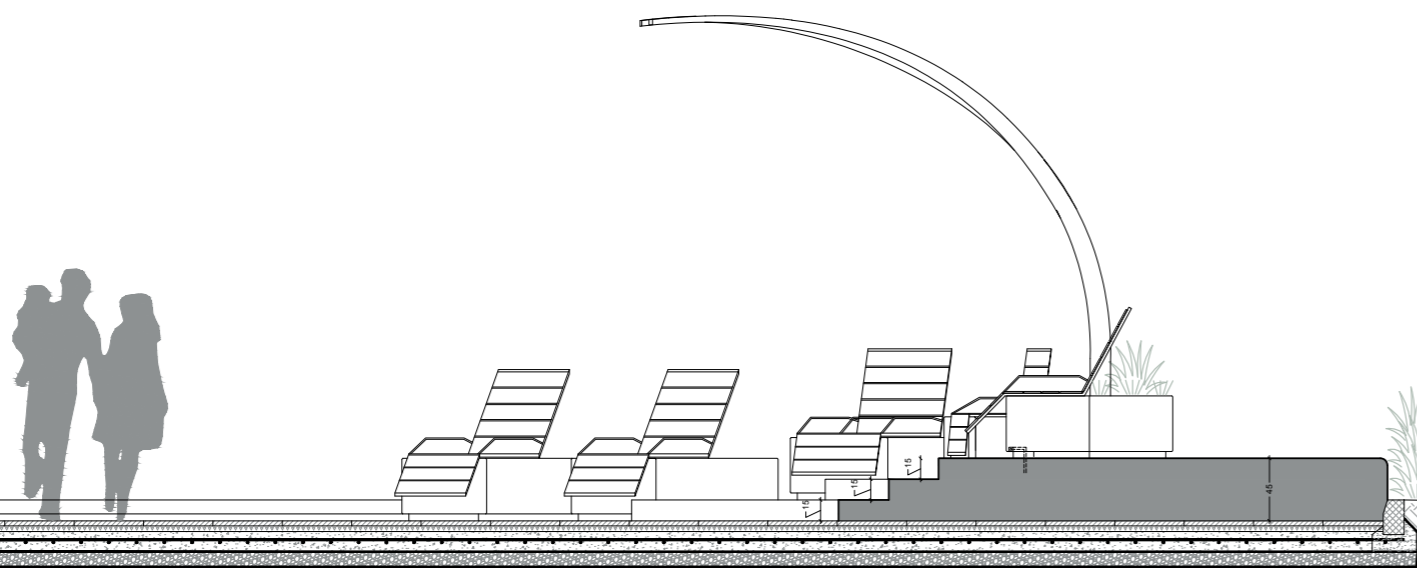



**MONOLITHIC,**  
an organic shape  
that seems designed by nature  
... the NUVOLA range

Organic shape Nuvola small planters, made of completely smoothed and anti-graffiti treated VUD01 Carrara white high-performance concrete.



**REVOLUTIONARY,**  
unconventional and  
far from the standards  
of the usual seats.

Monolithic Nuvola medium seats and Nuvola poufs, made of completely smoothed and anti-graffiti treated VUD01 Carrara white high-performance concrete.





VASART®

**PROJECT | SAVONA**

| FORTEZZA PRIAMAR – GIARDINO DEGLI AGRUMI |

12

- Project: "3S Studio Architetti Associati" Firm - Savona

## SAVONA IL GIARDINO DEGLI AGRUMI

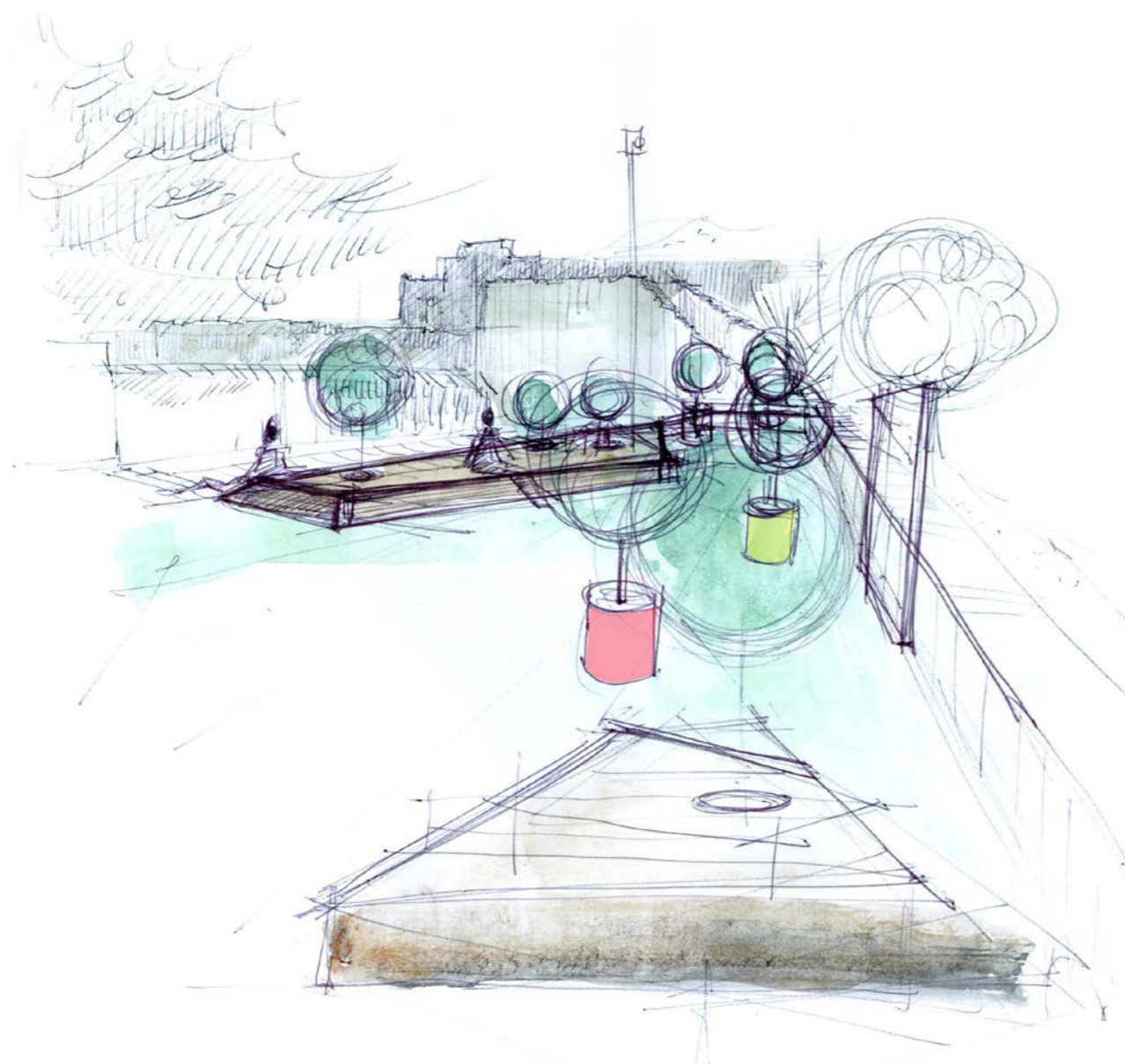

PRODUCT: LIVING LAB

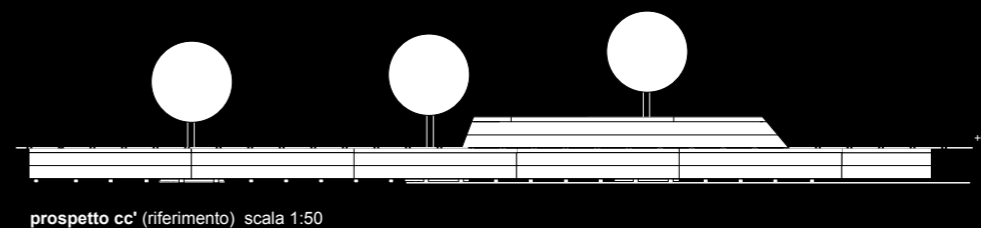

prospetto cc' (riferimento) scala 1:50

**PRODUCT: LIVING LAB**

- 01 | Seat covering with solid wood planks (oiled exotic essence) dimensions 16x6x200 cm
- 02 | Backrest position to complete seat
- 03 | Planter in galvanized steel according to standards EN UNI 10142, size diameter 80 cm and height 80 cm (height 43 for Chinotto trees) painted RAL as chosen by the D.L. (a different color for every essence)
- 04 | Chinotto di Savona trees (Citrus Myrtifolia) trunk circumference not less than 12 cm, foliage
- 05 | Corsican cedar trunk circumference not less than 14 cm, in a pot with a 5 cm covering of resinous bark or colored lapilli
- 06 | Structure in hot-dip galvanized steel distance between the transverse profiles 43 cm
- 07 | Galvanized steel plate for fixing boards
- 08 | 4\*4 cm profile in galvanized steel for fixing boards

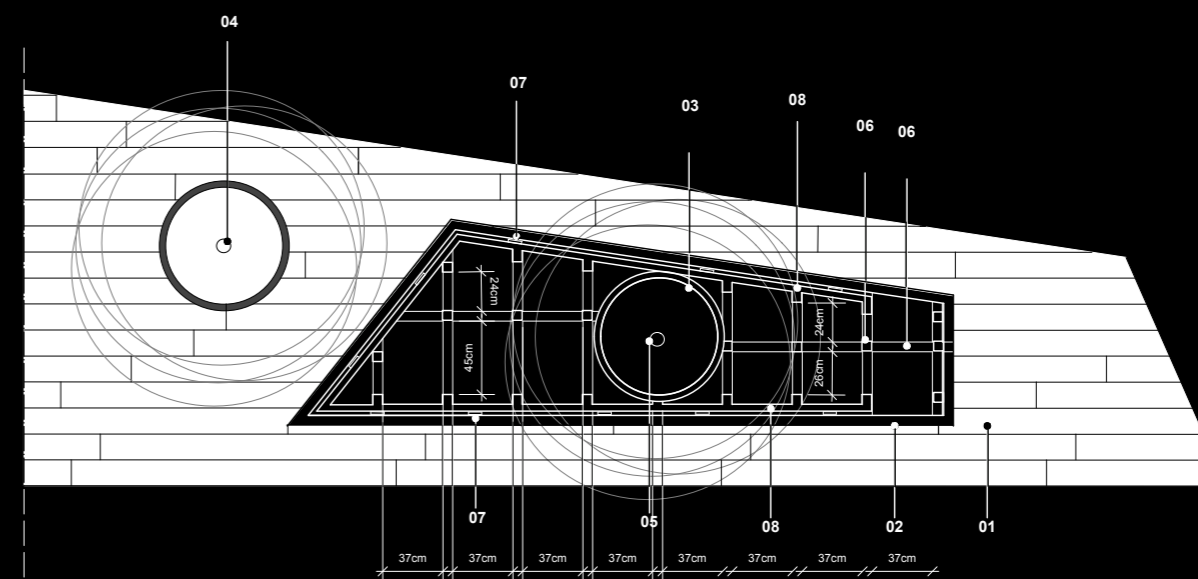

pianta quota +0,43 - particolare struttura 1° panca ( parte superiore/schienale) scala 1:25

### THE PROJECT

The project, in addition to the planting of 16 plants of citrus fruits in pots, also consists in the installation of seats in wood, a railing and new lighting.

## LIVING LAB: multifunctional isle

This multifunctional island is a system of seats and planters that can be custom made, or modular thanks to independent modules. The plan drawing has non-parallel sides that outline irregular but well-balanced volumes. These characteristic lines streamline the resulting shape and encourage a dynamic approach.

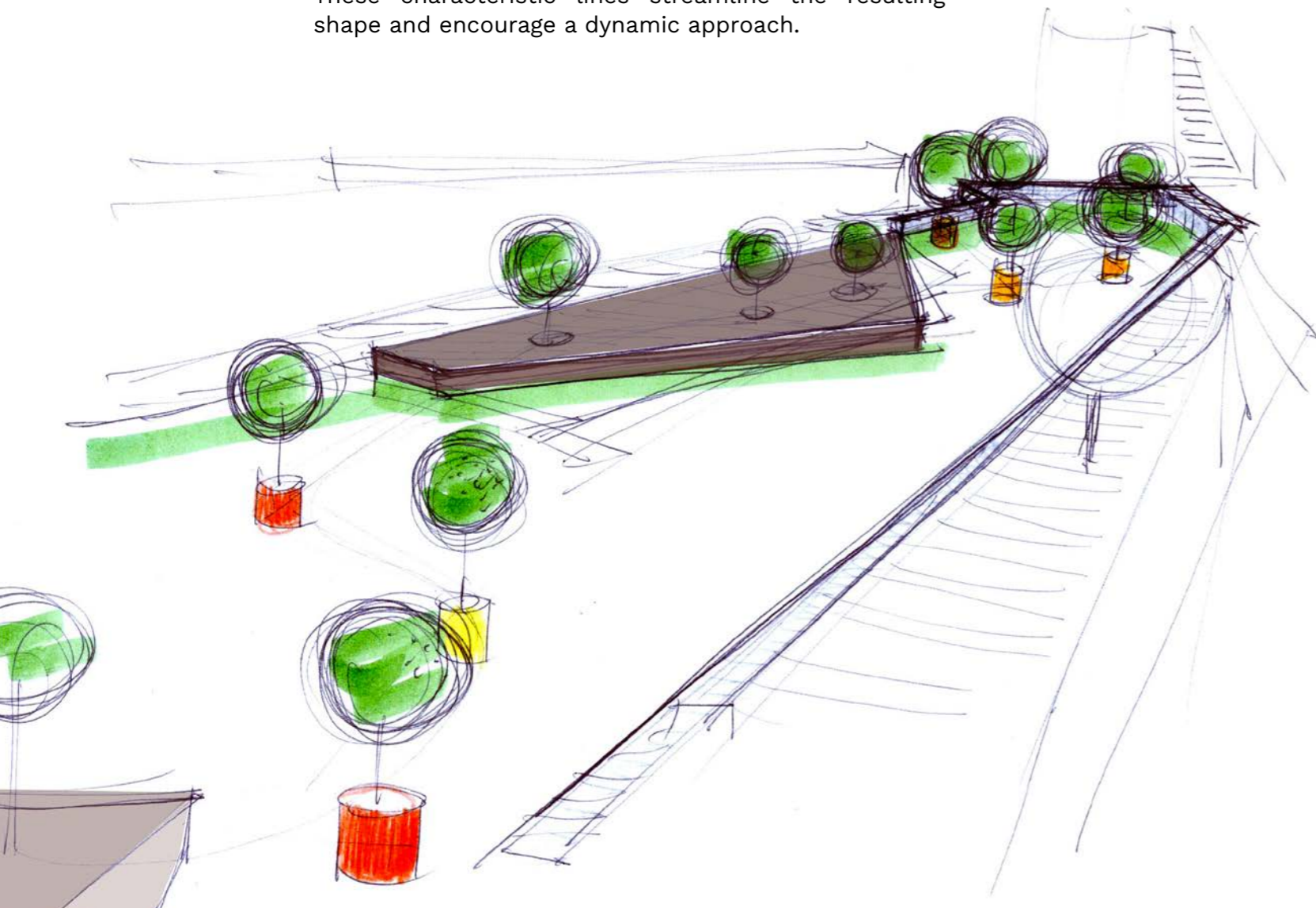

## LIVING LAB furnishing system

The Living Lab is a furniture system “to be experienced”, made to order and consists of a platform on which one can sit in a conventional way or relax comfortably leaning against backrests with different inclinations. The trees and flowers are an integral part of the structure, made of hot-galvanized steel tubing and covered in panels of exotic wood slats (wpc technical wood on request); the integrated planters are in hot-dip galvanized steel.

The Living Lab furnishing system is equipped with drip irrigation and LED lighting at the base. The hardware is in stainless steel.

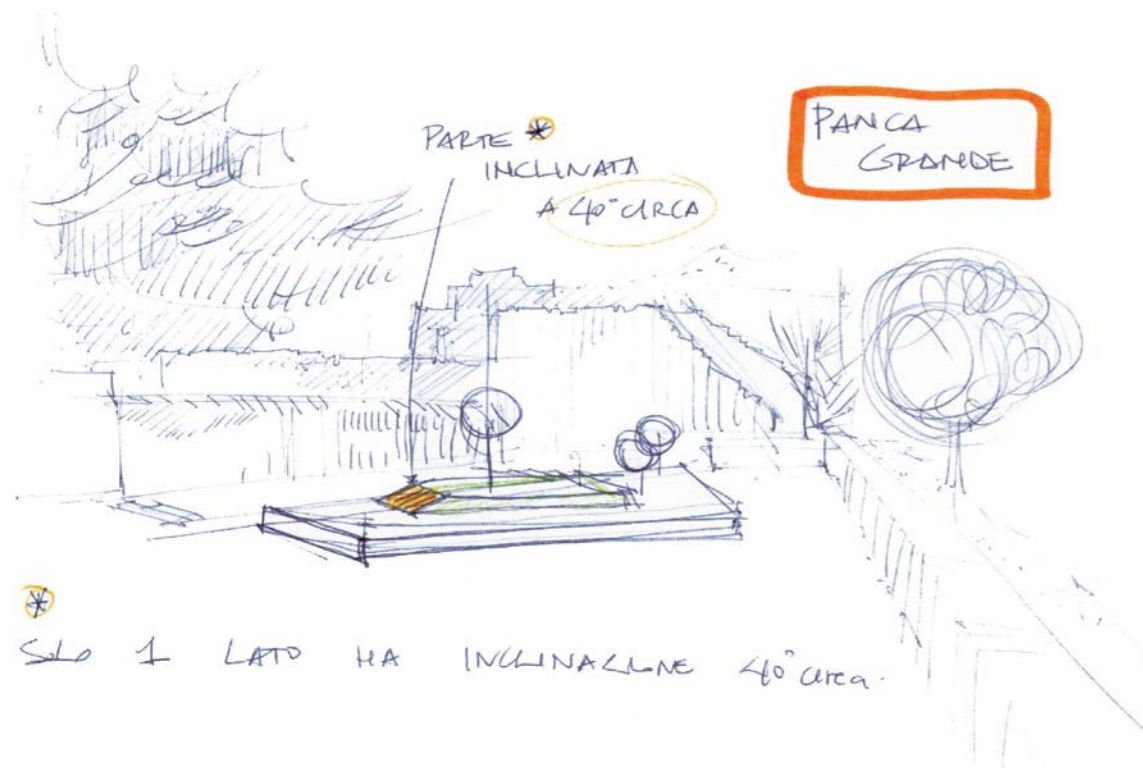

## IL GIARDINO degli agrumi

The protagonists of the garden are seven citrus fruits: the Chinotto of Savona, the Pernambuco Orange of Finale Ligure for the Liguria region; citrus fruits from the island of Elba for Tuscany; the Pompia for Sardinia, the Citron, the Clementine and the Corsican Pomelo to represent Corsica. The colored planters are made of hot-dip galvanized steel and powder coated for marine environment.





VASART®

**PROJECT | PARMA**  
| PIAZZALE PABLO |

03

- Project: Arch. Lucio Serpagli
- Client: Municipality of Parma

## PARMA

### PIAZZALE PABLO

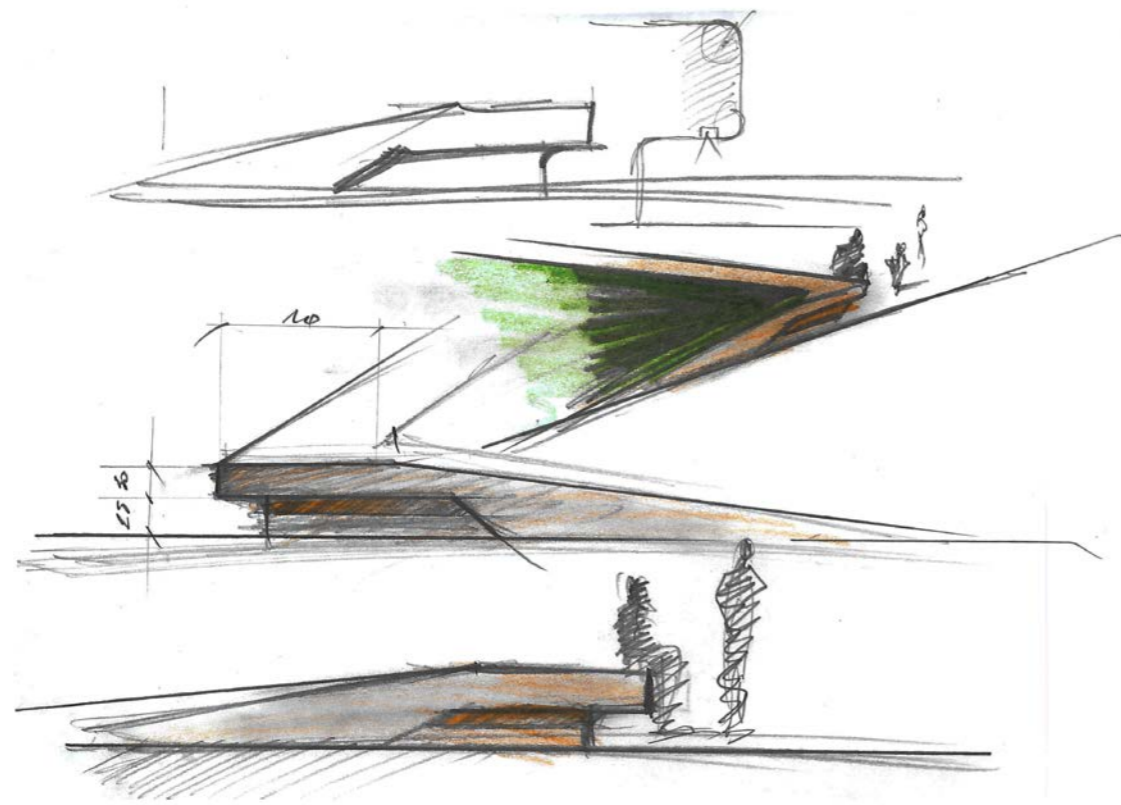

#### The perfect integration in an urban space

The redevelopment intervention in Piazzale Pablo in Parma is part of a series of actions that place the square at the center of a network of public spaces for the use of citizens.

The square is spread over a total area of approximately 5,700 square meters and the principles underlying the redevelopment interventions intended to make it a meeting and socialization place for the citizens of the neighbourhood.





## ENHANCING the surrounding spaces

The most characterizing furnishing elements of this intervention are certainly the curbs/seats made of VUD01 Carrara white high-performance concrete, completely smoothed and anti-graffiti treated, which start at level from the sidewalk and rise towards the central strip of the square, to define the seat.

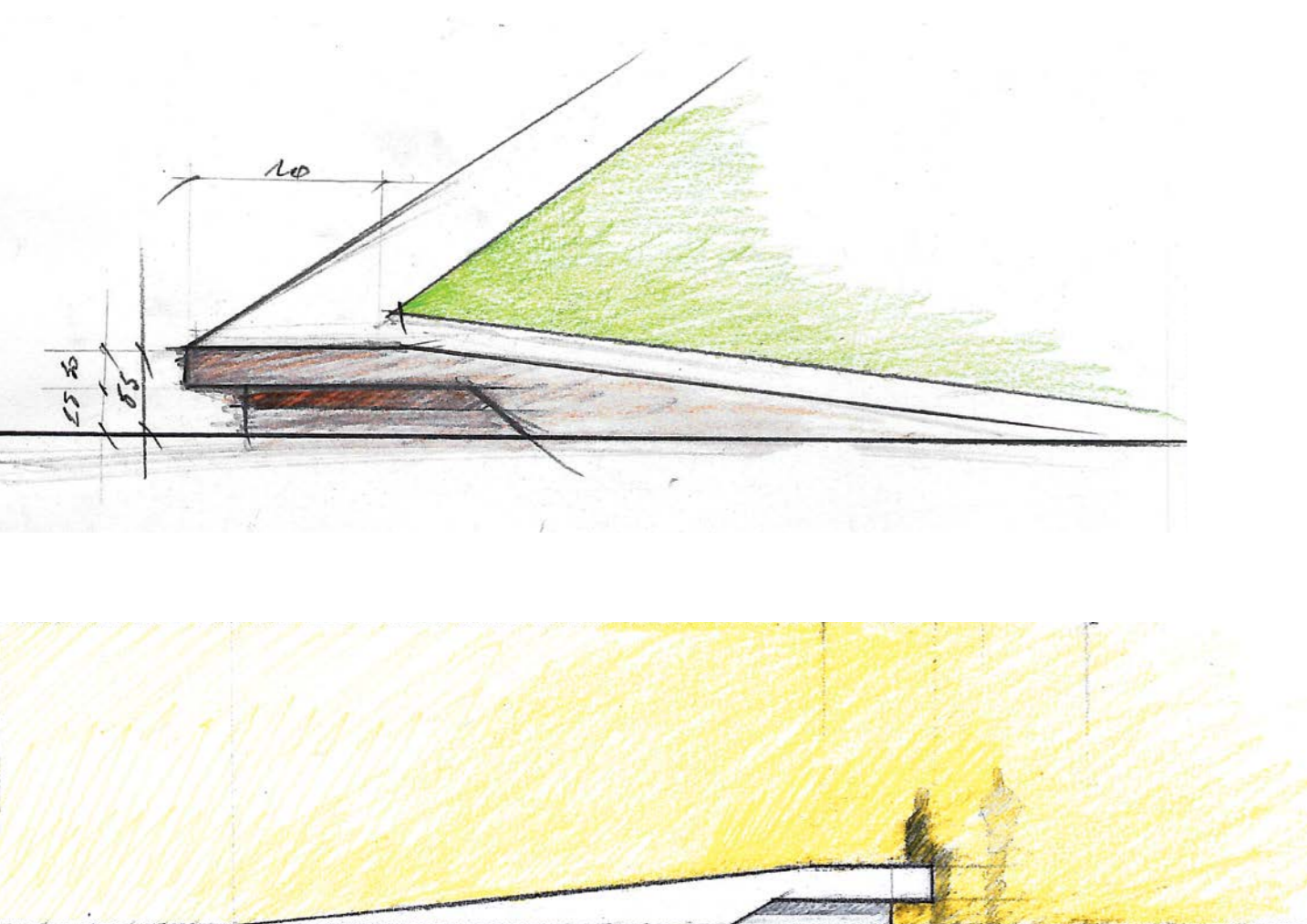



## INSPIRATION and PROJECT



PABLO BENCH

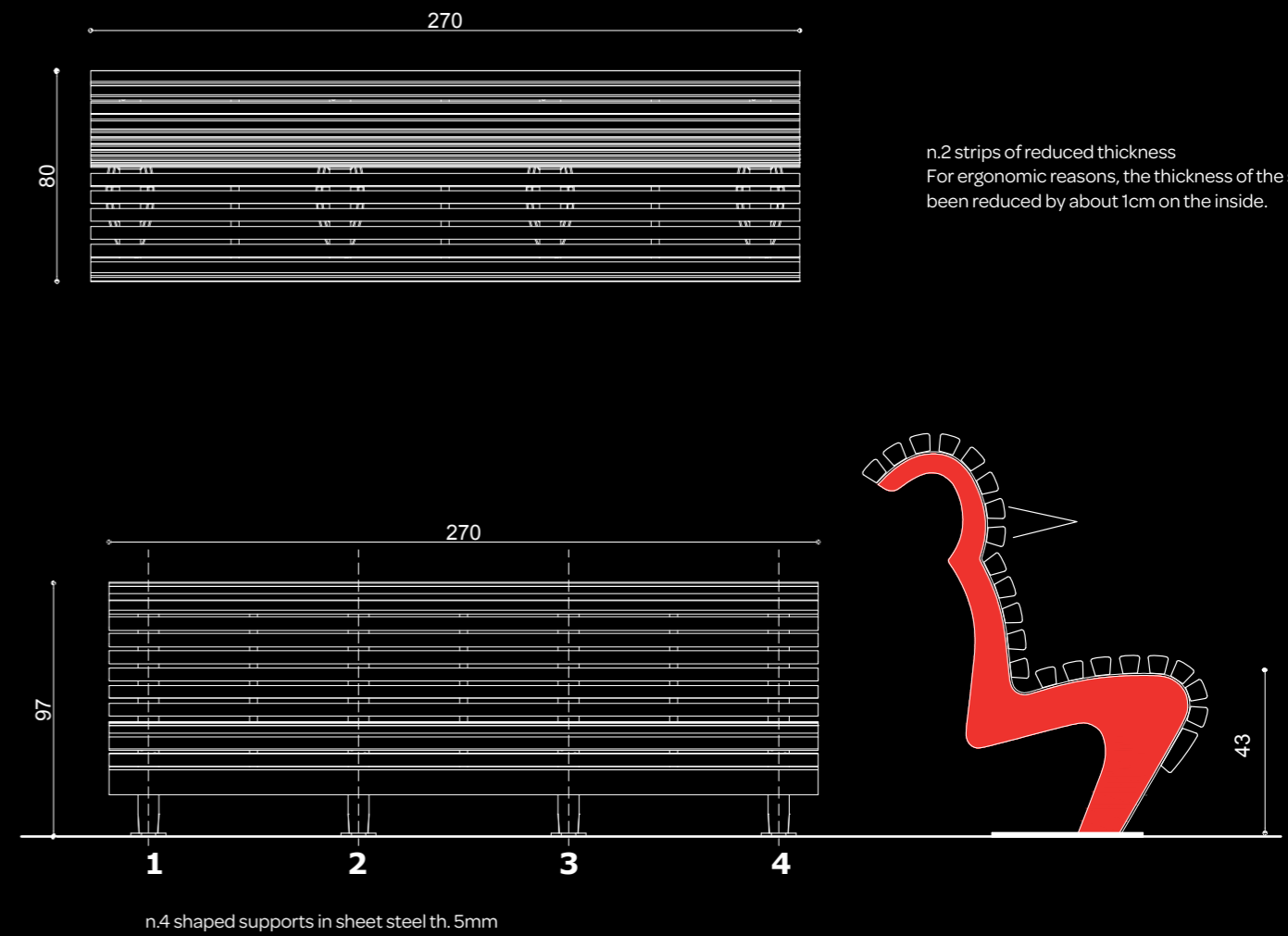

PABLO BENCH

Made of treated exotic wood slats and sides in laser-cut, hot-dip galvanized and powder-coated steel (stainless steel bolts and nuts).

## Ergonomic DESIGN

Next to the area dedicated to children's games, some benches designed ad hoc by the architect Lucio Serpagli have been installed.





VASART®

**PROJECT | MILANO**  
| PIAZZA FERNANDA PIVANO |

04

- Project: Arch. Massimo Roj
- Client: Beni Stabili Development Spa

## MILANO PIAZZA FERNANDA PIVANO

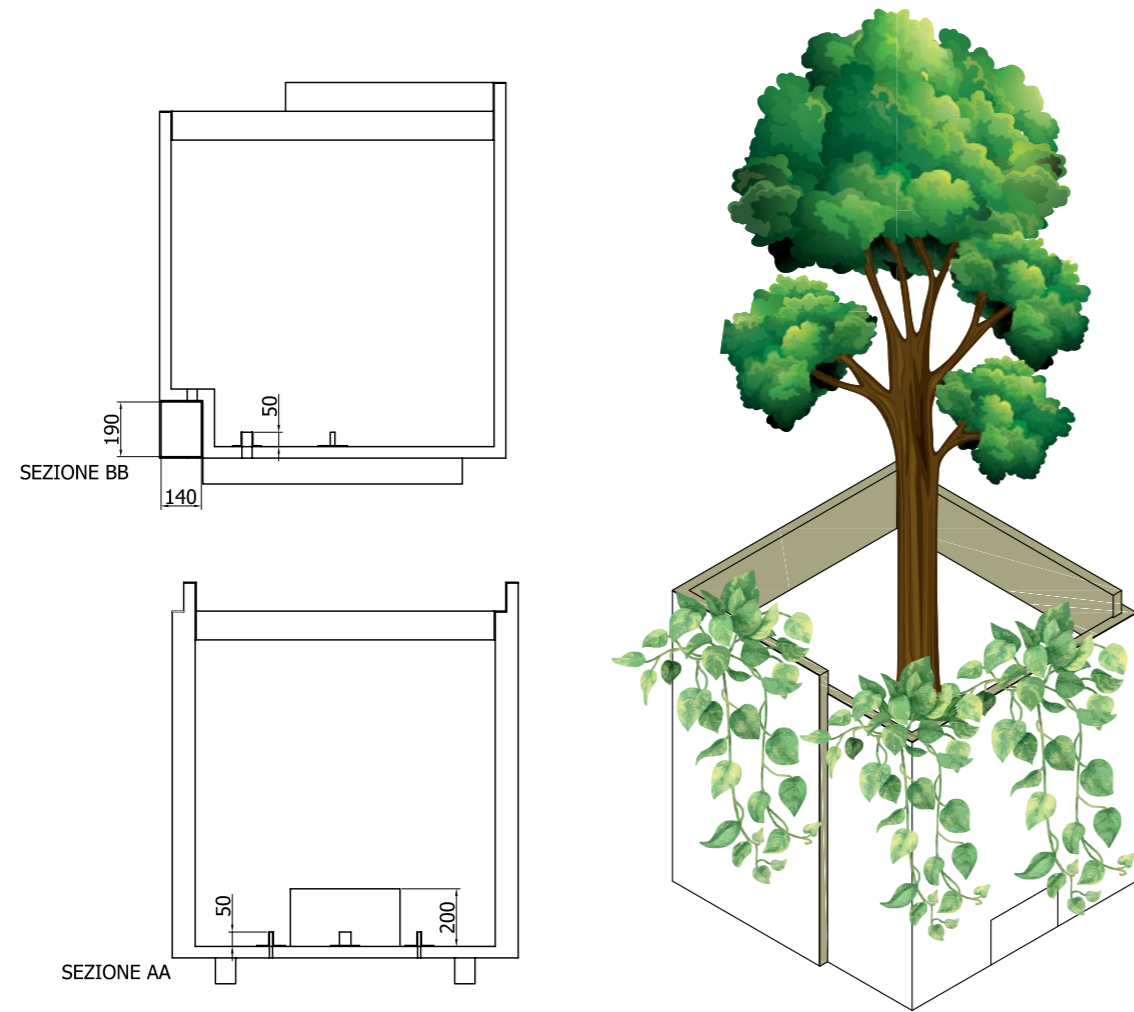

### “Green” REDEVELOPMENT

The new 4 thousand square meter square has been furnished and enhanced with 35 planters designed by Arch. Massimo Roj, benches, flower beds and water features.



## MILANO

PIAZZA FERNANDA PIVANO

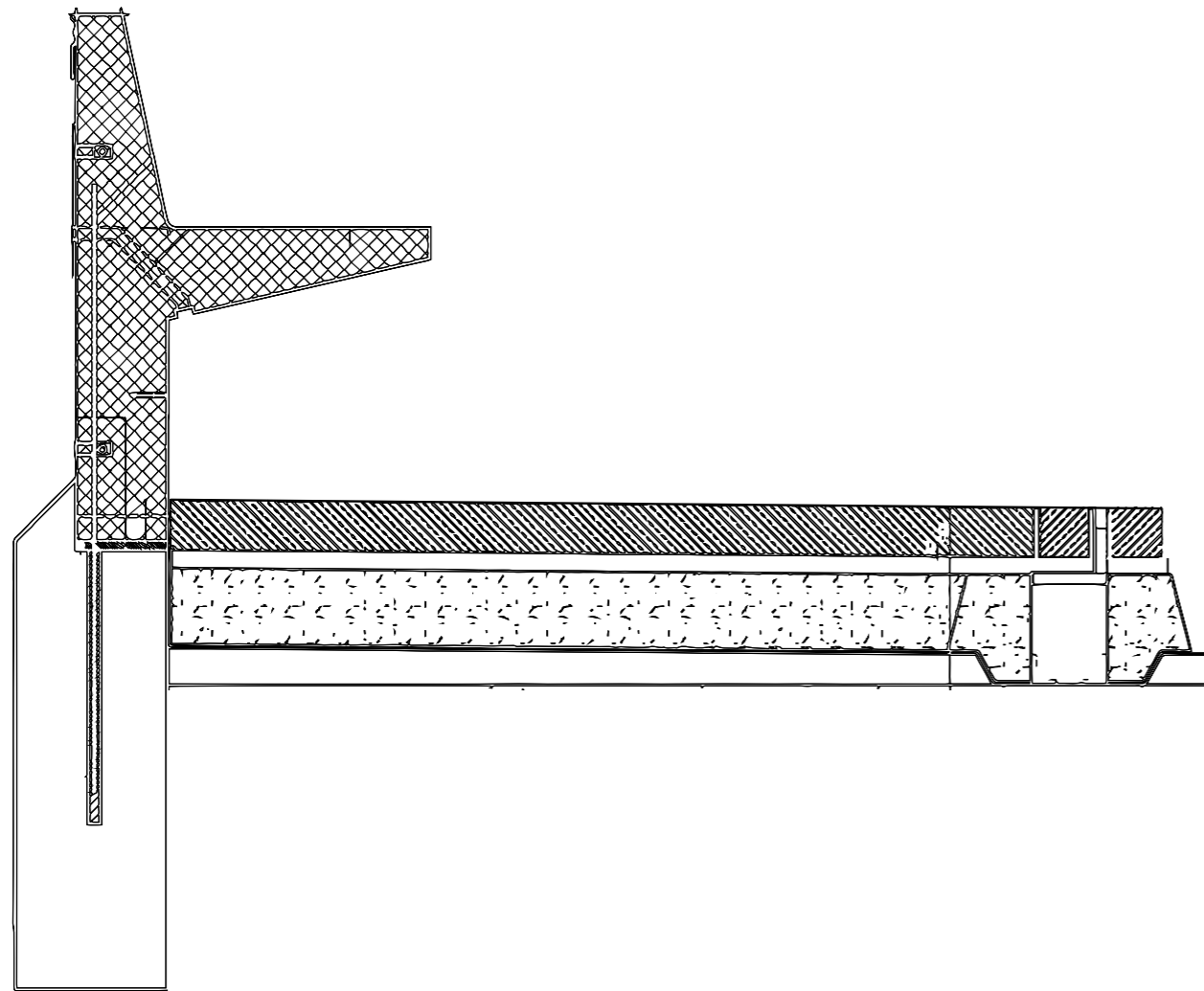

### BENCH

A cantilevered bench, complete with backrest, in exposed reinforced concrete, borders the square on one side.







## Urban REGENERATION

The new square named after Fernanda Pivano was created by Covivio as part of The Sign, the urban regeneration project that is transforming an industrial area from the 1950s into a new innovative and technological hub.

The area has about 35 trees and flower beds in continuity with the green system around the Iulm University and the recently redeveloped Russoli park, as well as benches and wi-fi connection.





VASART®

**PROJECT | VARIGOTTI**  
| PASSEGGIATA LUNGOMARE |

05

- Project: *N2m* Arch. Marinella Orso  
Orso studio Arch. Michela Ruffini
- Client: Municipality of Finale Ligure (SV)

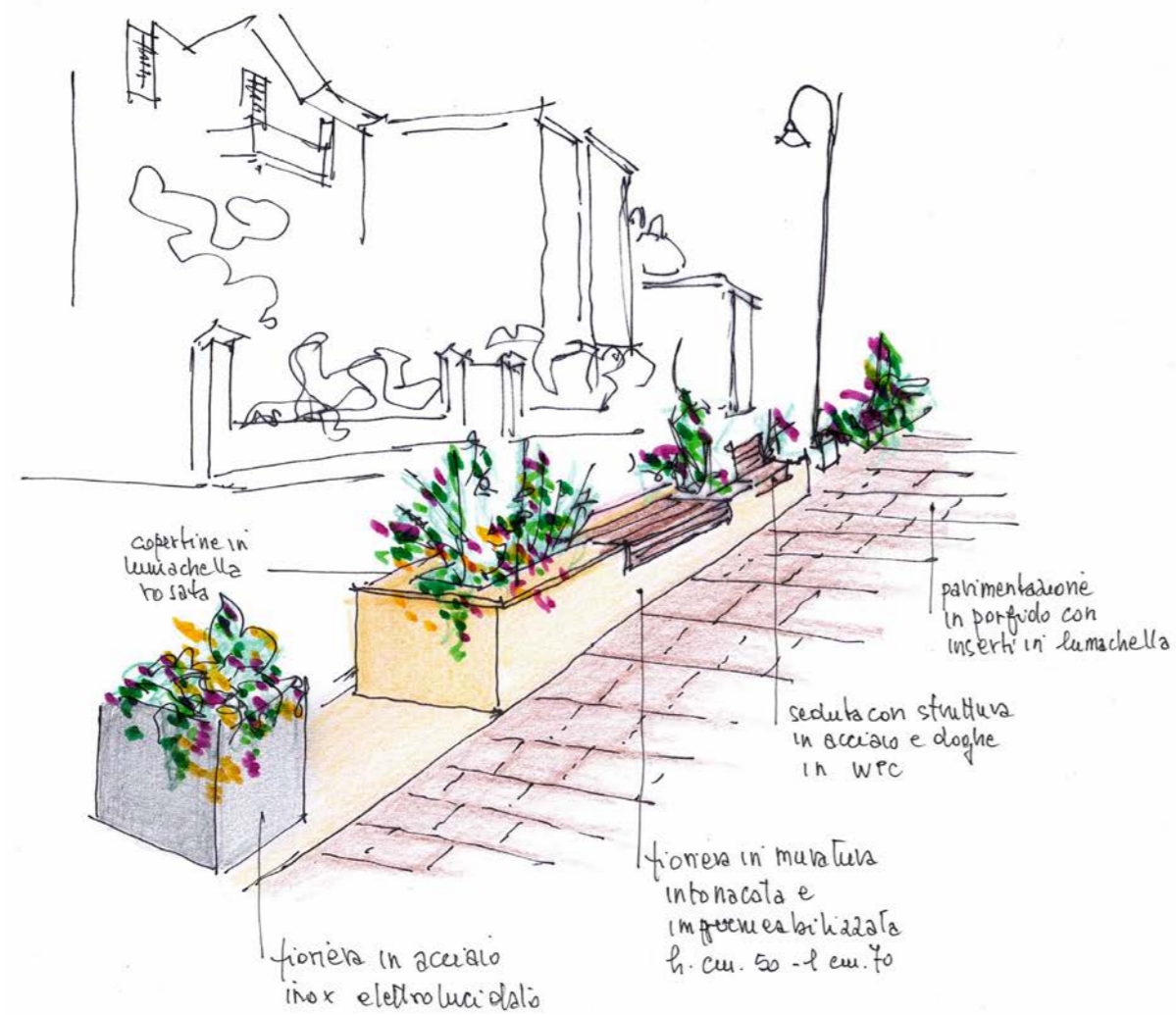

## THE PROJECT

The design intervention was set considering the enhancement of the relationship between users and the sea “resource” as the primary objective, simultaneously promoting the creation of a single coastal system, directly connected with the city, capable of guaranteeing an environmental rebalancing, ecological and landscape capable of intensifying the levels of overall use.



ENHANCEMENT and  
REDEVELOPMENT PROJECT  
of the "PASSEGGIATA VARIGOTTI"

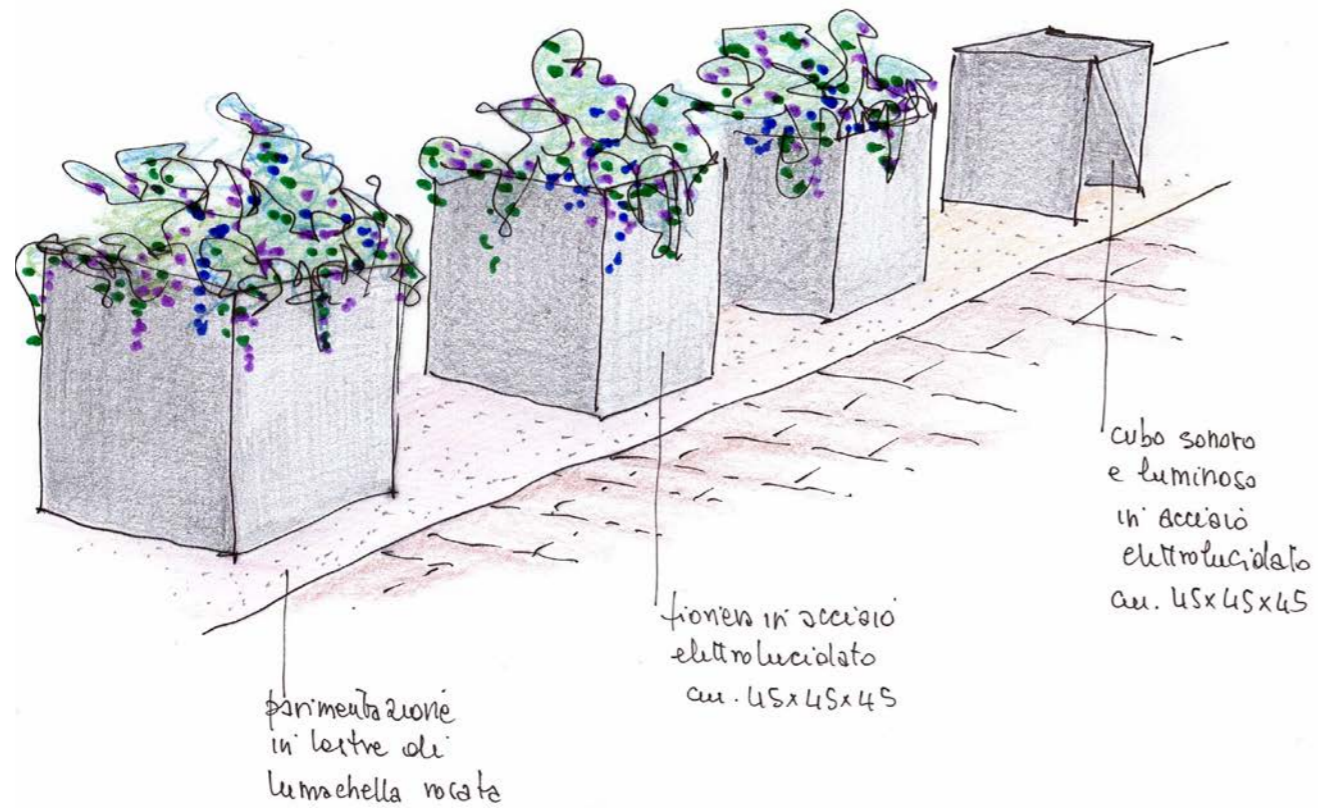

### "CUBE" planter

Cube-shaped planter with 450 mm side, made of electro-polished AISI 304 stainless steel th. 2 mm, fixed to the ground using special dowels and complete with drip irrigation.

The designer's signature *N2m* design studio is laser engraved.

SOUND (and of light) DIFFUSER: cube-shaped element with 450 mm side, made of electro-polished AISI 304 stainless steel with th. 2 mm, fixed to the ground using special dowels and featuring:

- sound system for the diffusion of music
- hole at the base and diagonal metal sheet for the diffusion of light from the ground





## VARIGOTTI PASSEGGIATA LUNGOMARE

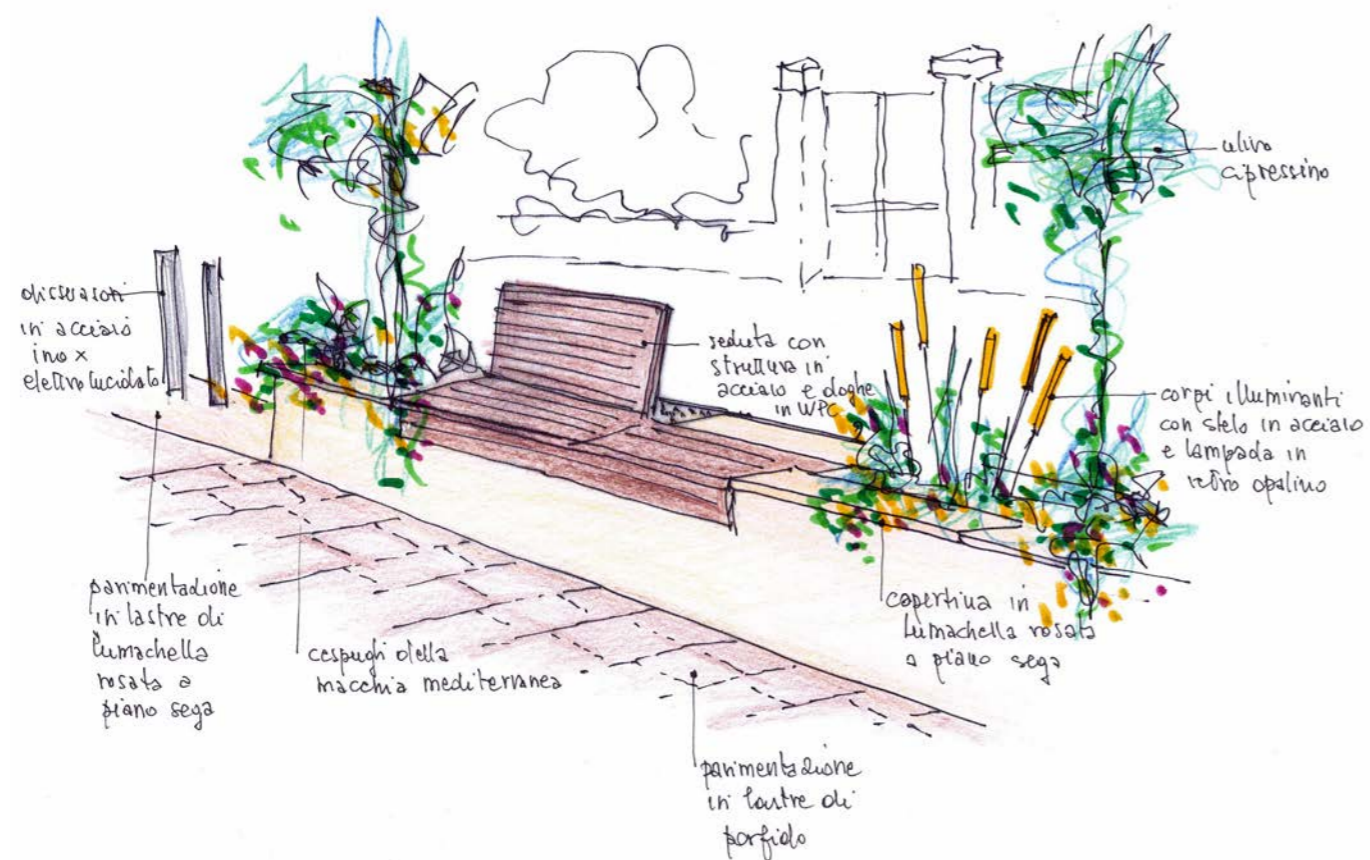

### “COVER” benches

COVER benches are made with backrest or flat structure, with an electro-polished AISI 304 stainless steel plate frame and wpc (technical wood) slats. The benches are fixed and built into the planters made on site.





## GATE BARRIER

Made of electro-polished AISI 304 stainless steel plate of th. 8 mm, complete with 200x150 mm base fixed to the ground with 4 dowels. Height from the ground mm 1000.



## VARIGOTTI PASSEGGIATA LUNGOMARE

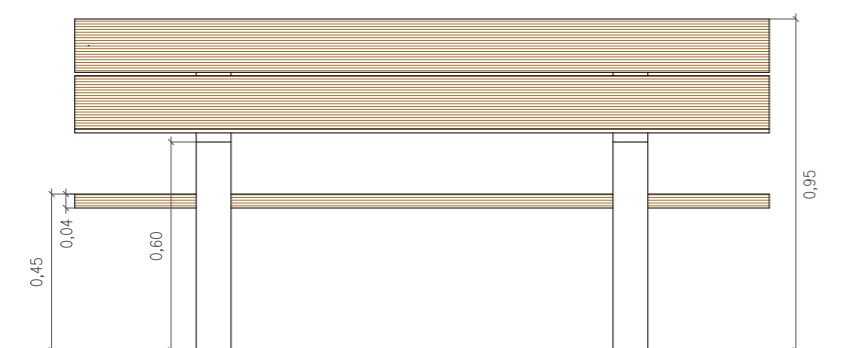

PROSPETTO - Vista frontale

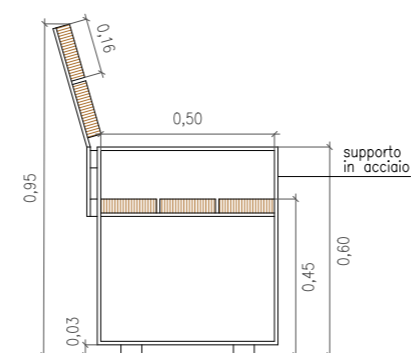

PROSPETTO - Vista laterale

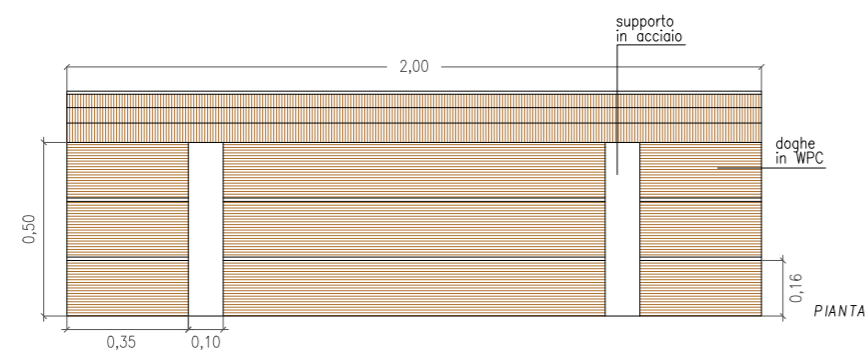

### “LUNGOMARE” bench

Made with frame in electro-polished AISI 304 stainless steel plate of th. 8 mm and reinforced wpc (technical wood) slats, complete with backrest and armrests, fixed to the ground using special dowels.





VASART®

**PROJECT | BELLARIA**  
| PASSEGGIATA LUNGOMARE |

06

- Project: LAPRIMASTANZA
- Contractor: Impresa Mattei Srl
- Client: Municipality of Bellaria - Igea Marina (RN)

## BELLARIA PASSEGGIATA LUNGOMARE

SAND CURB/SEAT

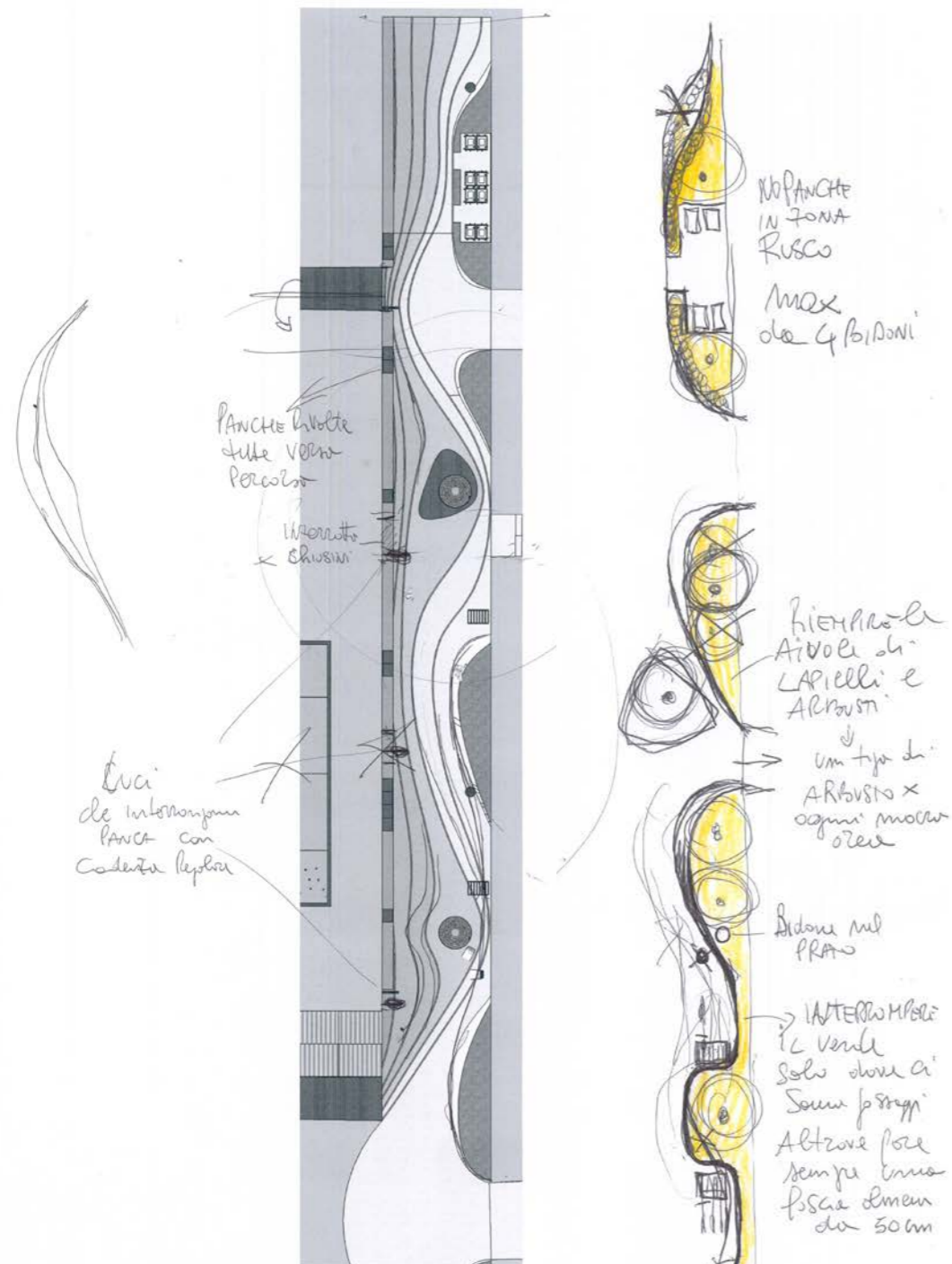

Photo: Lorenzo Burlando

### "SAND" CURB/SEAT

The SAND curb/seat is made up of 15 "complex" modules that can be connected to each other (which have 45 individual pieces) and is made of completely smoothed and anti-graffiti treated VUD01 Carrara white high-performance concrete.



## WATERFRONT: a place to stay



Along the entire west side of the Viale there is a green band with sinuous shapes. It is a real ecological corridor with tall plant species and native low green shrub species; this green system is outlined by a sinuous and dynamic white curb which often becomes a bench to allow users to sit comfortably in the shade and catch some fresh air.

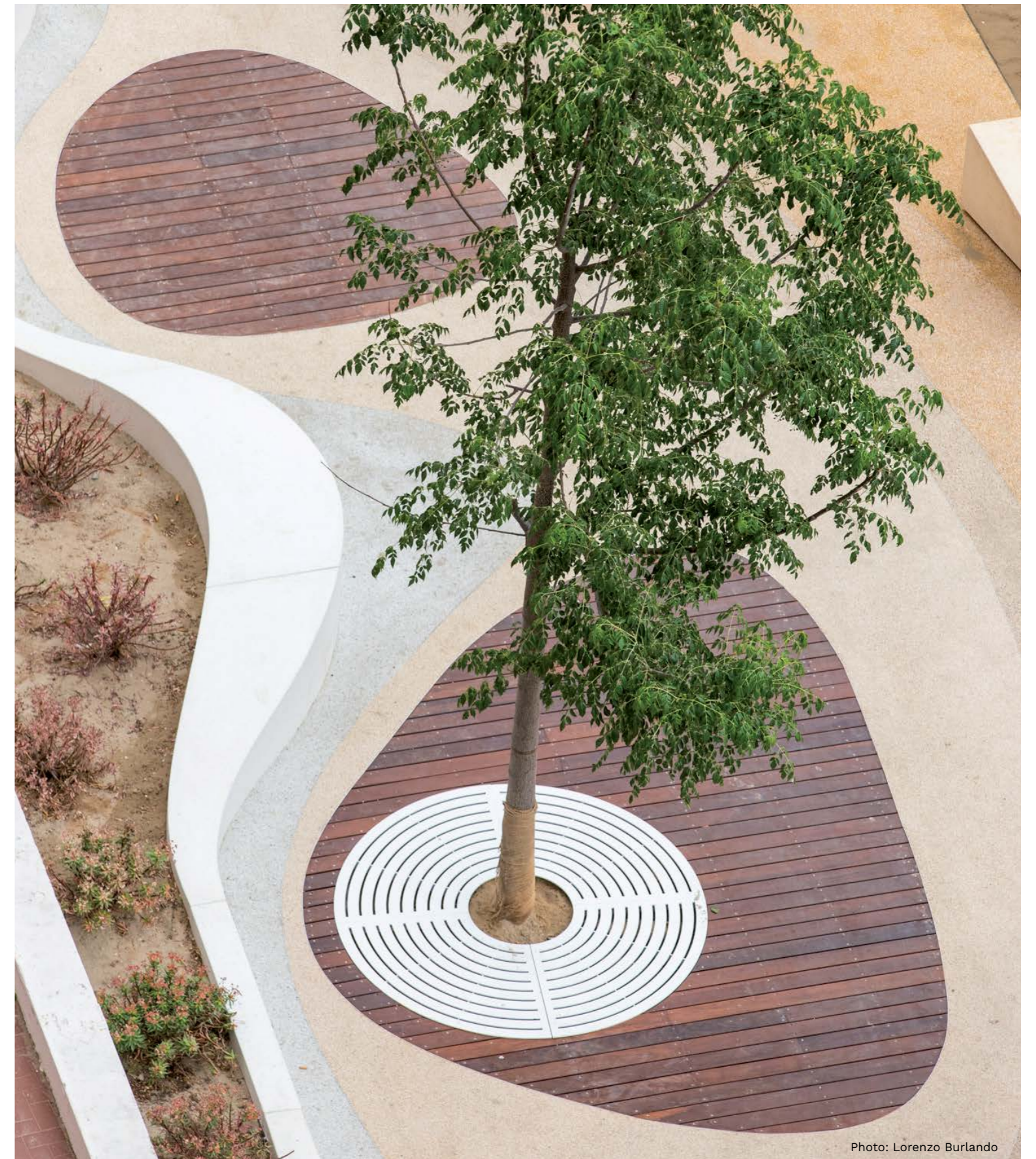

## A PLACE to meet



The project generates a real promenade, a place to meet, chat, share. An inclusive place where you can stop thanks to the generous presence of seats along the east and west strip of the route, a place where you can take a break in the shade of project's high and low green system, refresh yourself at the numerous fountains and stop in one of the many drop-shaped decking in ipè wood.



Photo: Lorenzo Burlando

## "ROCK" SEATS

The ROCK benches have been designed in 8 different models in terms of shape and size; they are made of completely smoothed and anti-graffiti beige high-performance concrete. They can be equipped with a COVER single seat with backrest, made of ipe wood slats and painted stainless steel frame.







## THE NEW urban furniture

The new waterfront, named after Raffaella Carrà, is a system of new visual cones to the sea, forcing the beach houses and kiosks/bars to settle in specific positions, thus freeing up excellent visual glimpses along the whole beach.



## WITH NEW glimpses towards the sea

In this way the view of the sea is brought not only to the seafront but right into the hinterland of the city; between the orthogonal meshes of the urban area of Bellaria it will thus be possible to have glimpses towards the sea and a precious consequent spatial orienteering for the tourist.



VASART®

PROJECT | SAN MAURO MARE  
| WATERFRONT |

07

- Project: LAPRIMASTANZA
- Client: Municipality of San Mauro Pascoli (FC)

## SAN MAURO MARE LUNGOMARE



### WATERFRONT regeneration

The project of the San Mauro Mare waterfront considers this walk along the coast as the synthesis of a series of strategic themes. It is a driveway and cycle path accompanied by a large pedestrian space.





## A PROMENADE

where to meet

An inclusive place where you can stop thanks to the generous presence of seats along the sea side, a place where you can take a break in the shade.

In the square, a delicate system of bands and infographics in street prints on the ground in the warm colors of the lands design the spaces in a sparkling and playful way and guide the visitor along the entire avenue.

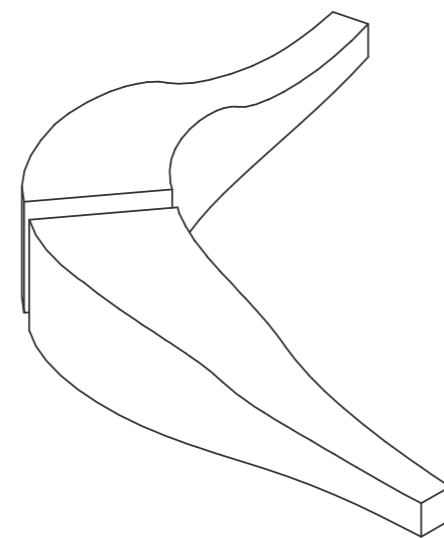
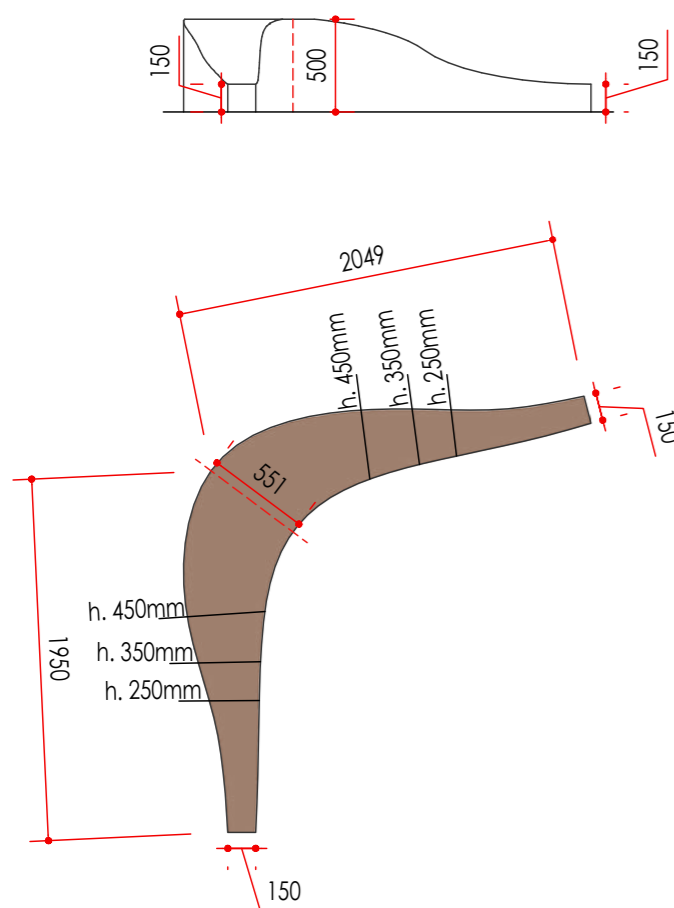

- One of the 5 complex modules created for this project







VASART®

**PROJECT | REGGIO EMILIA**  
| PIAZZA GIOBERTI |

08

- Project: Andrea Oliva Architetto – Studio CittàArchitettura
- Client: Municipality of Reggio Emilia
- Photos: Kai Uwe-Schulte Bunert

## REGGIO EMILIA PIAZZA GIOBERTI

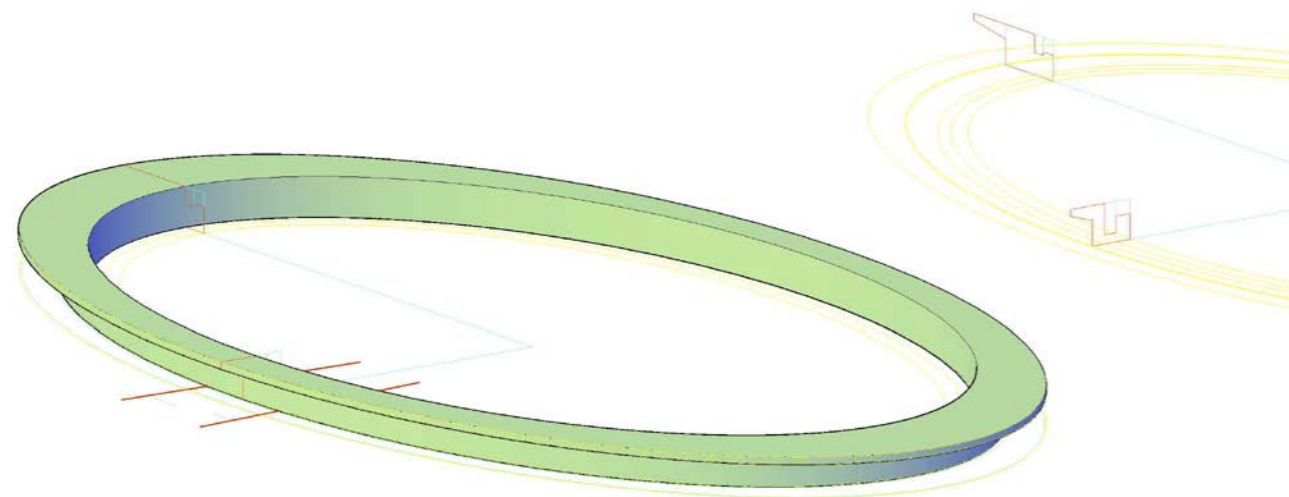

### Elliptical SHAPE BASIN

The crowning element of the Obelisk in Gioberti square has been redesigned with an elliptical basin (which absorbs the geometric and perspective inhomogeneities of the square), a sort of “mirror” and a 3 cm “veil of water”, which recalls the taste of the Estes for water games.



## A functional and aesthetic SEAT

The basin has a cantilevered edge on the floor, made up of the juxtaposition of VUD03 high-performance concrete ashlar, in river white colour, completely smoothed and anti-graffiti treated, which acts as a seat, creating a space for rest and contemplation in the center of the square.





VASART®

**PROJECT | PIETRA LIGURE**  
| PIAZZA VITTORIO EMANUELE |

09

- Project: Arch. Barbara Cuomo
- Client: Municipality of Pietra Ligure (SV)

## PIETRA LIGURE

### PIAZZA VITTORIO EMANUELE



#### NATURE AND MATERIAL

##### A perfect balance

A new concept of urban furniture that combines a different lifestyle in the public space that goes hand in hand with the regeneration of green while respecting the natural environment.

Perspective view

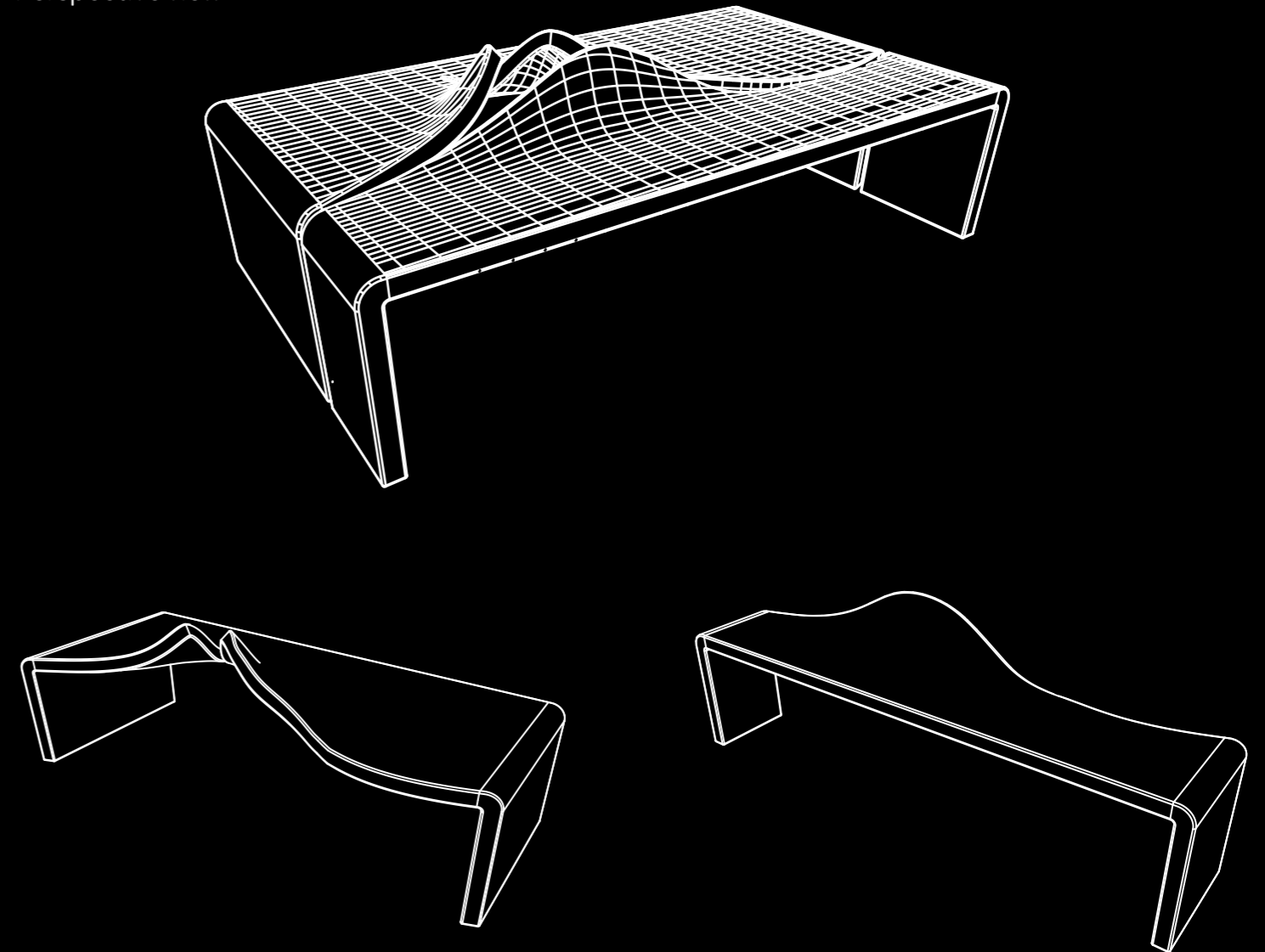

#### "SPLIT" PLANTER

##### with seat

The bench can be single or coupled, and the wooden backrest and flower box are available as options. The matching tree grate completes the collection.

## Geometric CONTRASTS

The small sprout that splits the hard concrete and grows in its arms, a symbol of nature within the built: this is the Split collection!

Among the other peculiarities of the new square, the type of flooring certainly stands out, made up of white and gray tiles placed in such a way as to create an undulating pattern.







VASART®

**PROJECT | CATTOLICA**  
| LUNGOMARE RASI SPINELLI |

10

- Project: Medaarch
- Client: Municipality of Cattolica
- Works management: Geom. Rossini Fabio and Ing. Magnani Giulia (Sector 05 | Public Works)
- Contractor: CBR - Cooperativa Braccianti Riminese

## CATTOLICA

### LUNGOMARE RASI SPINELLI



#### EIGHT HUNDRED METERS of waterfront in all its beauty

Eight hundred meters of waterfront with a total width of over 20 meters and with a visual effect that does not interrupt but restores visibility towards the horizon, thanks to solutions that have replaced the old road platform (pedestrian, vehicular and cycle lanes) in itself discontinuous, both in terms of materials and dimensions, with a single platform with uniform characteristics.





PROJECT:

**Panchina A.1 - panchina tipo**  
**Rappresentazione dettagliata in pianta e prospetto**

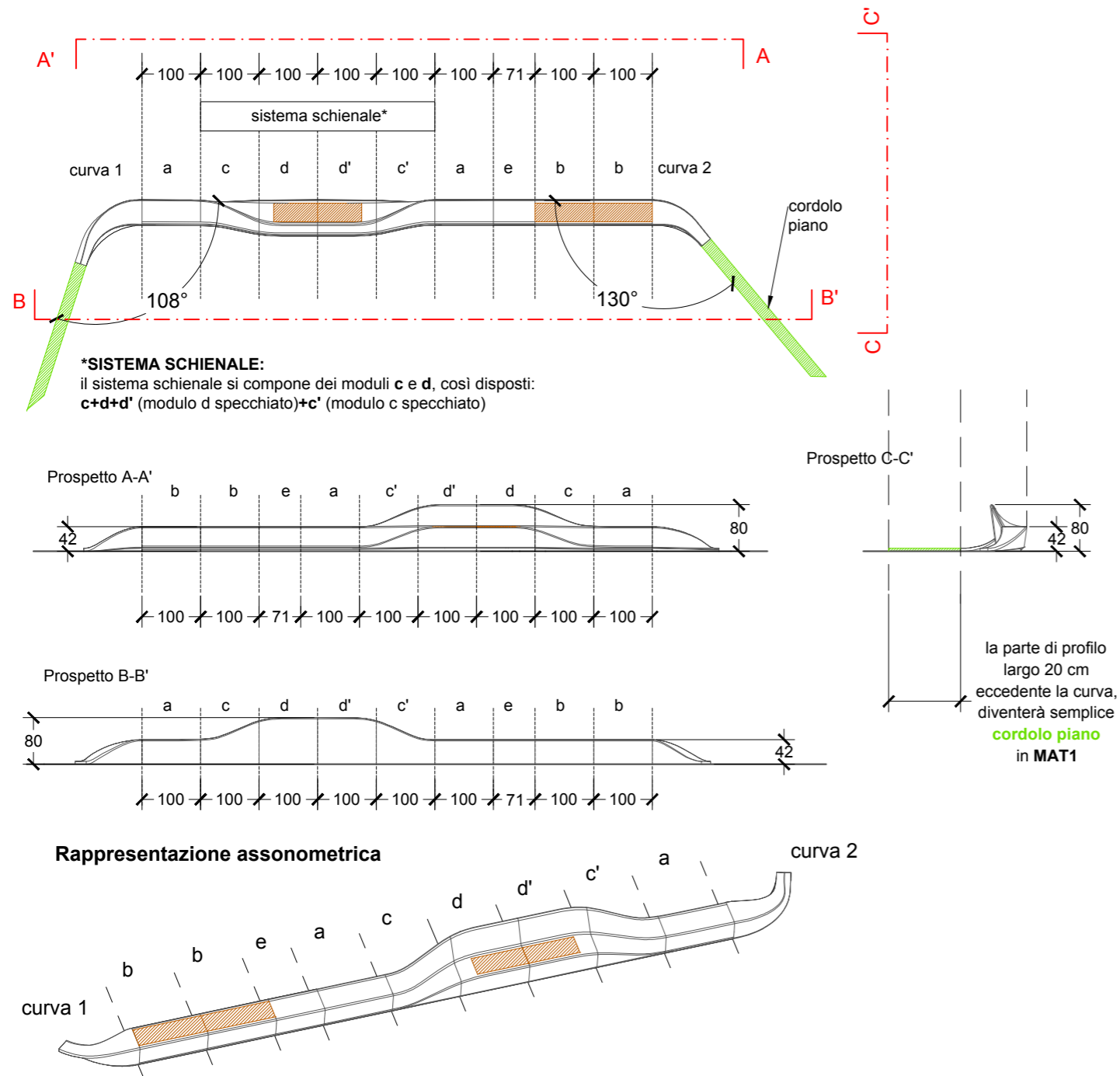

**REDEVELOPMENT WITH:**  
**Green Spaces,**  
**Cycle Lanes**  
**and Relax Areas**

Cattolica's new waterfront is equipped with greenspaces, cycle paths, relax areas and redeveloped squares, therefore new spaces for socializing; the design of particular modular seats that delimit and contain the green spaces is the distinctive feature of this ambitious and successful redevelopment project, which restores a modern and functional image to the city of Cattolica.



“Promenade range”

## PROJECT ELEMENTS

- Bench with 400 cm monobloc backrest made of sand-coloured VUDB02 high-performance concrete, completely smoothed and anti-graffiti treated, complete with seat in wpc technical wood slats with stainless steel frame.
- Flat linear bench, complete with seat in wpc technical wood slats with stainless steel frame.
- 300 cm flat linear bench.
- Curves of 90°/108°/130° in altitude.
- Flat curves with seat depth change for connection to the beach level.
- Flat curves of 90°/105°.
- “Terminal” curves for the elevated area.

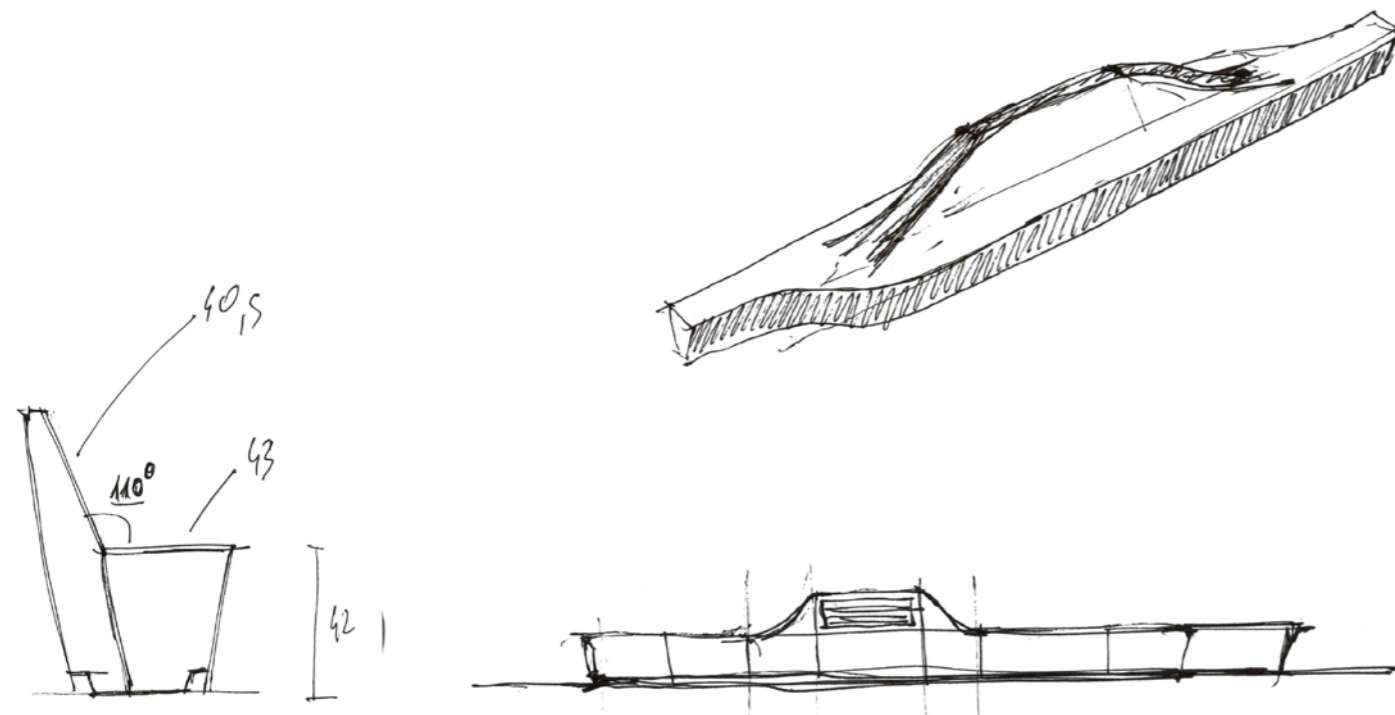







## CATTOLICA LUNGOMARE RASI SPINELLI



### MODULAR BENCHES that become flowerbeds

The other modular bench (both also serve as containment of the flower beds), is located on the side facing the sea and serves to connect the level of the seafront promenade to the beach level.

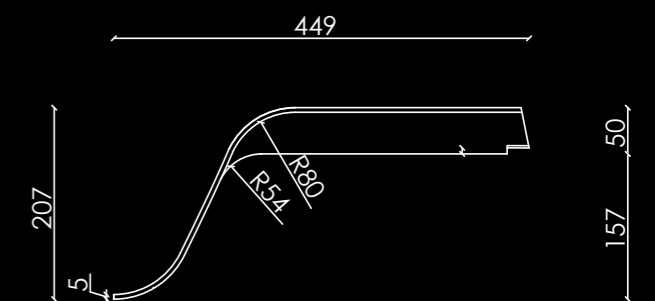
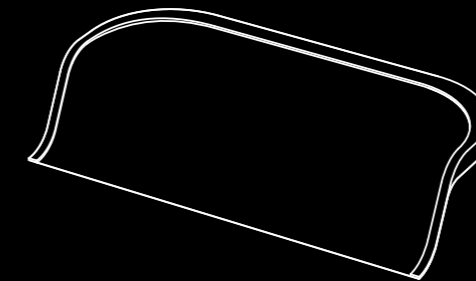
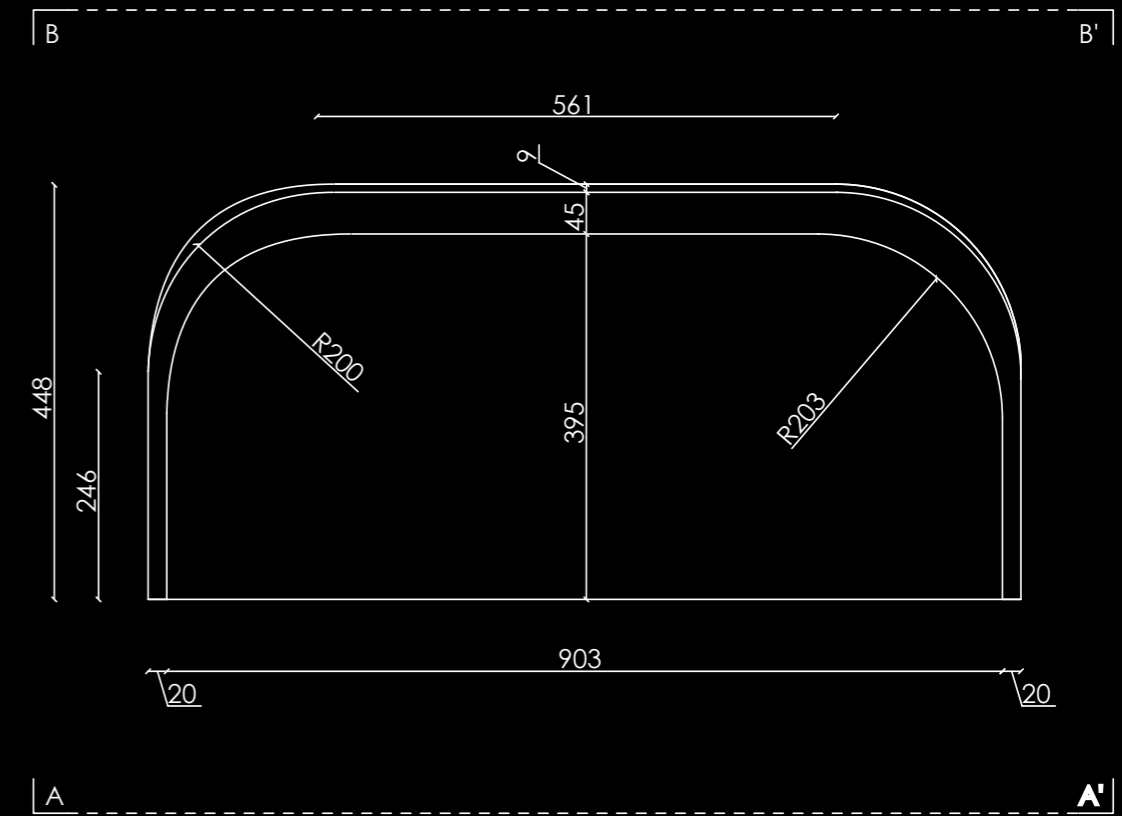

## HARMONY

that leads to the sea

This bench develops flat and is complete with curves that connect to the wall connecting the two levels (promenade/beach).

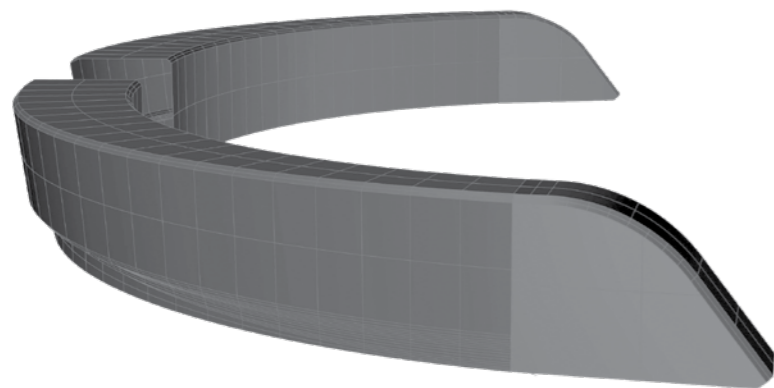



VASART®

**PROJECT | SALUDEGIO**  
| PIAZZA SANTO AMATO RONCONI |

11

- Project: Technical Office Vasart Urban Design
- Client: Municipality of Saludecio (RN)

## SALUDECIO PIAZZA SANTO AMATO RONCONI



### DEFINING SPACES BY FURNISHING

The goal of the project was to furnish the square by delimiting a “pedestrian” area that can be used for events and shows and leaving limited transit for crossing the square.

Two project variants and two different colors have been proposed.

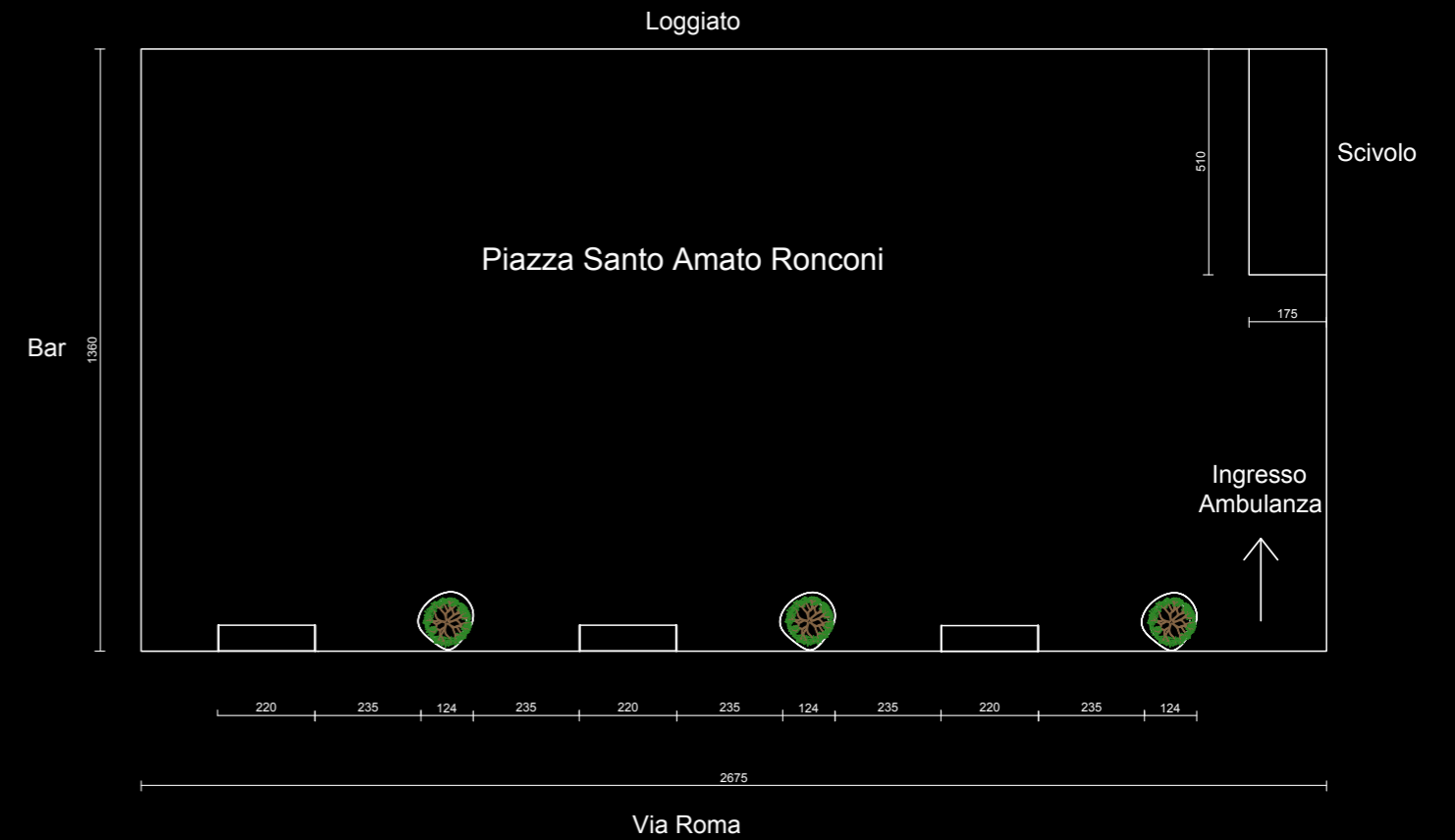

### BENCH PLANTER

Light and material are some of the inspiring definitions of these benches and planters, protagonists of the urban redevelopment of the square, integrating perfectly with the most significant buildings such as the imposing church.

## DESIGNED

by the wind

Inspired by a new architectural philosophy: the NUVOLA benches and planters are revolutionary, unconventional and far from standard. The monolithic and smoothed surfaces are made of VUDNO1 high-performance concrete, in black colour, completely smoothed and treated with transparent anti-scratch paints.





VASART®

**PROJECT | MARINA DI OLBIA**  
| TOURIST PORT |

12



- Project: Arch. Marcello Michiara
- Client: Immobiliareuropea S.p.a.

## MARINA DI OLBIA PORT

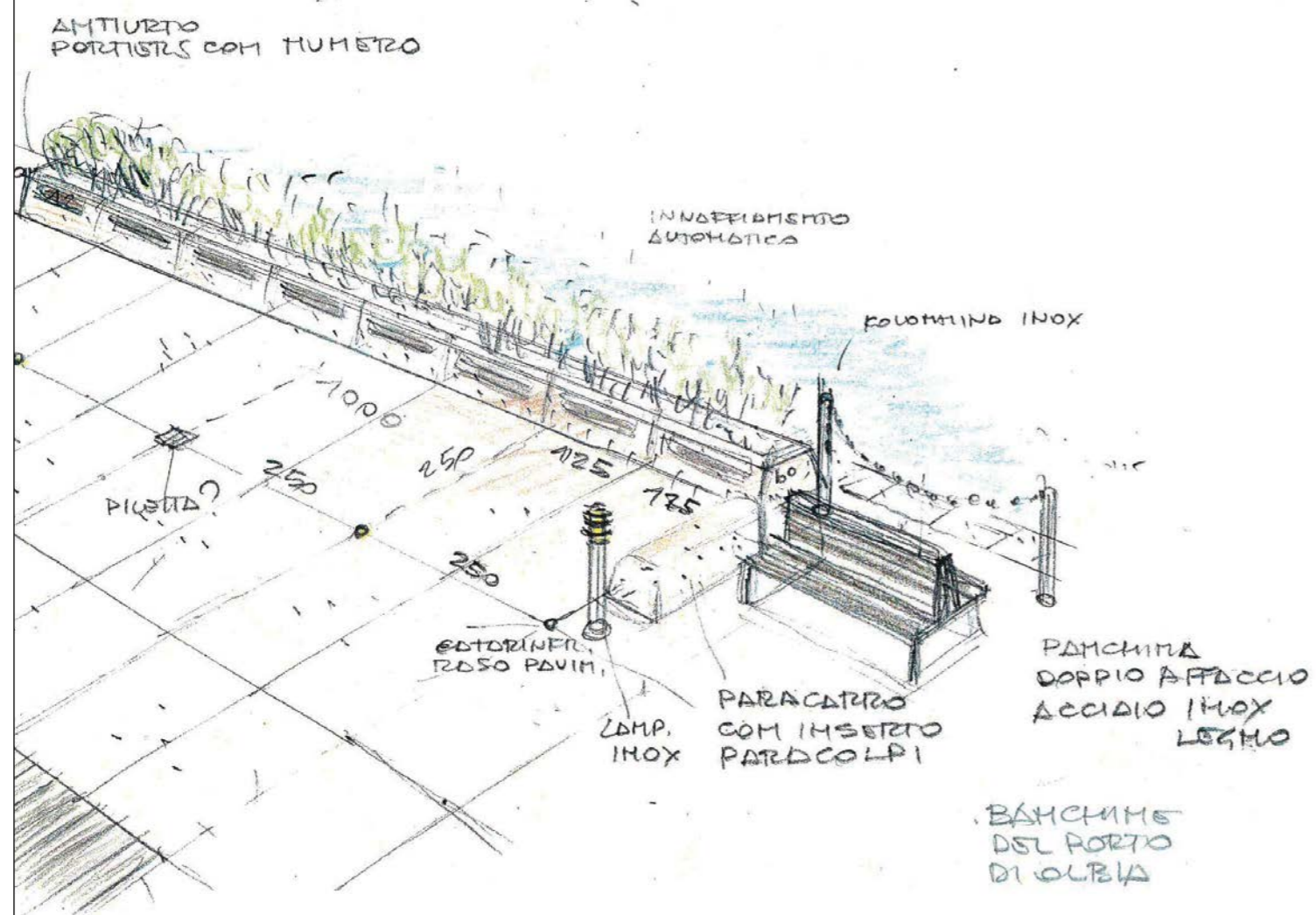

“MAXIMUM RESPECT  
FOR THE ENVIRONMENT,  
TOTAL SAFETY”

The main concept of this project is a spot, but the perimeter of the port that barely touches the rocks on the water's surface is a faithful snapshot of our successful attempt to harmonize the impact on the environment.

## PHILOSOPHY

The whole structure was designed and built to limit the environmental impact as much as possible and guarantee excellent resistance in the marine environment.

The beige color of all the elements made in bush-hammered concrete (planters, thresholds of the platforms and curbs), which integrates perfectly with the rock and sand of the place, is the result of careful research and many samplings.

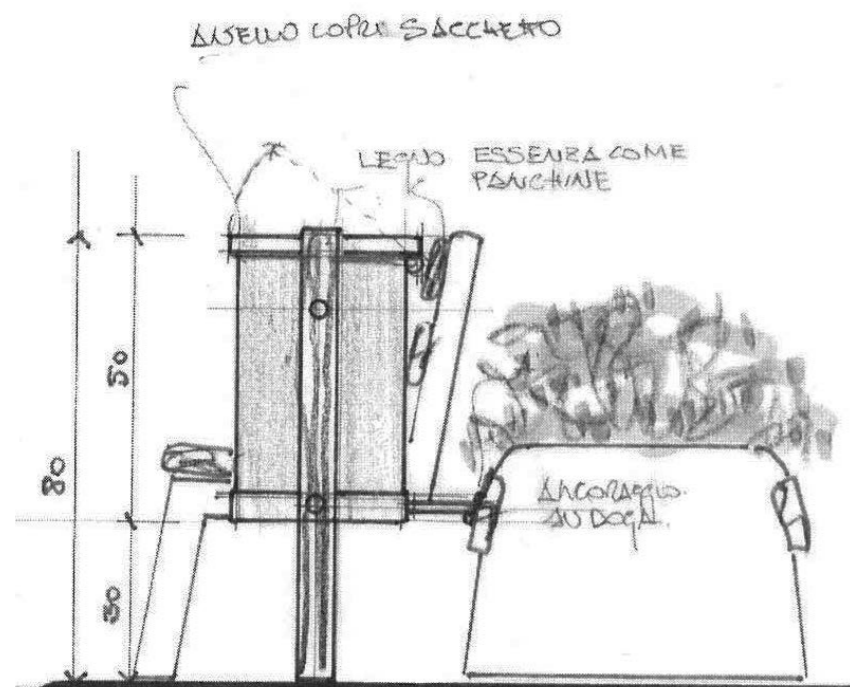

# THE IMPORTANCE of materials

The wood used for the barriers and for the decoration of the planters is a very resistant exotic wood (teak).

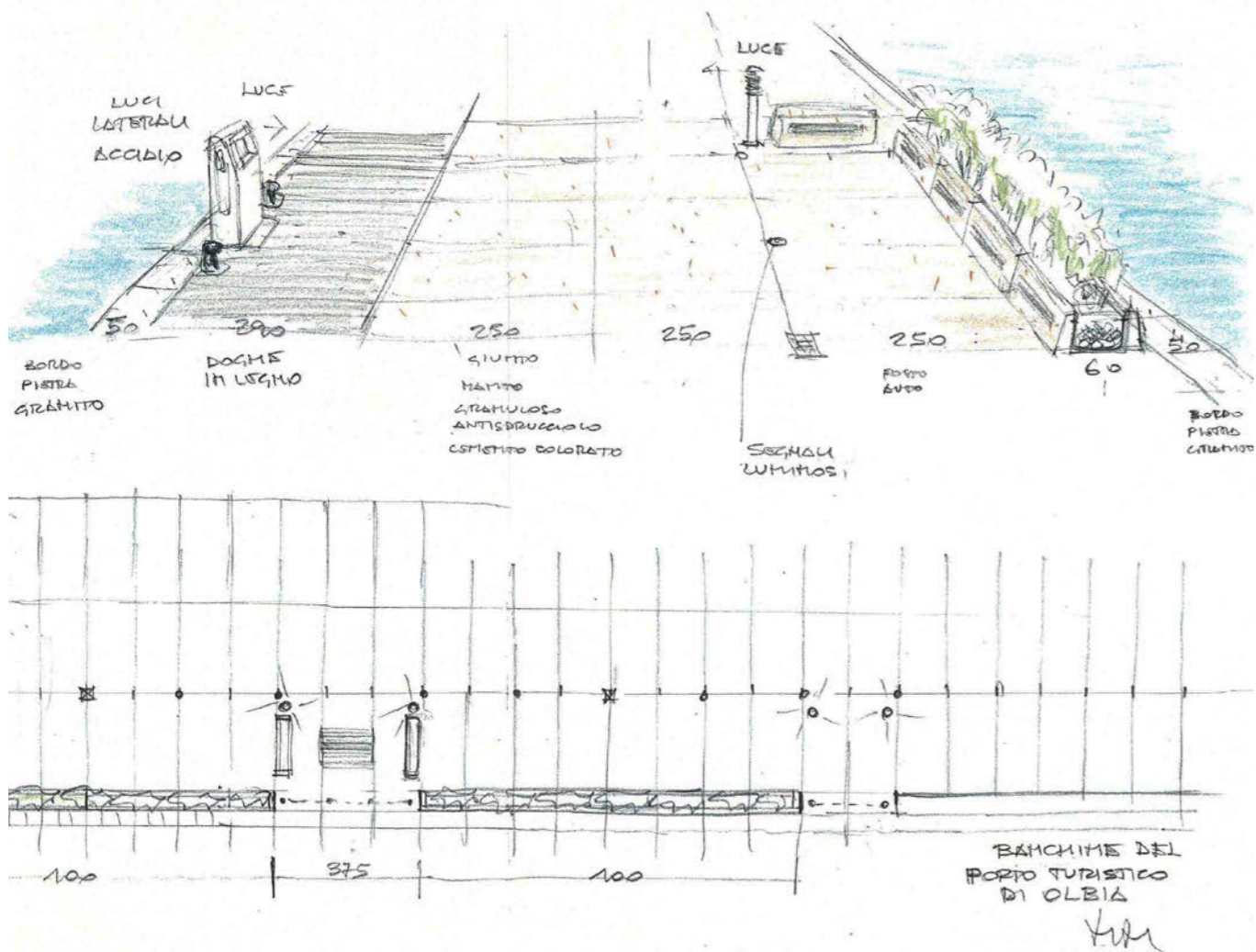

## INTEGRATION

with nature

The barriers and all the wooden and stainless steel furnishings integrate perfectly into the port environment.

All these furnishing elements are now part of the Mediterranea Range.



VASART®

**PROJECT | RICCIONE**  
| CORSO FRATELLI CERVI |

13

- Project: 3S studio
- Client: Geat Srl (RN)

## RICCIONE CORSO FRATELLI CERVI

LAYER PLANTER WITH SEAT



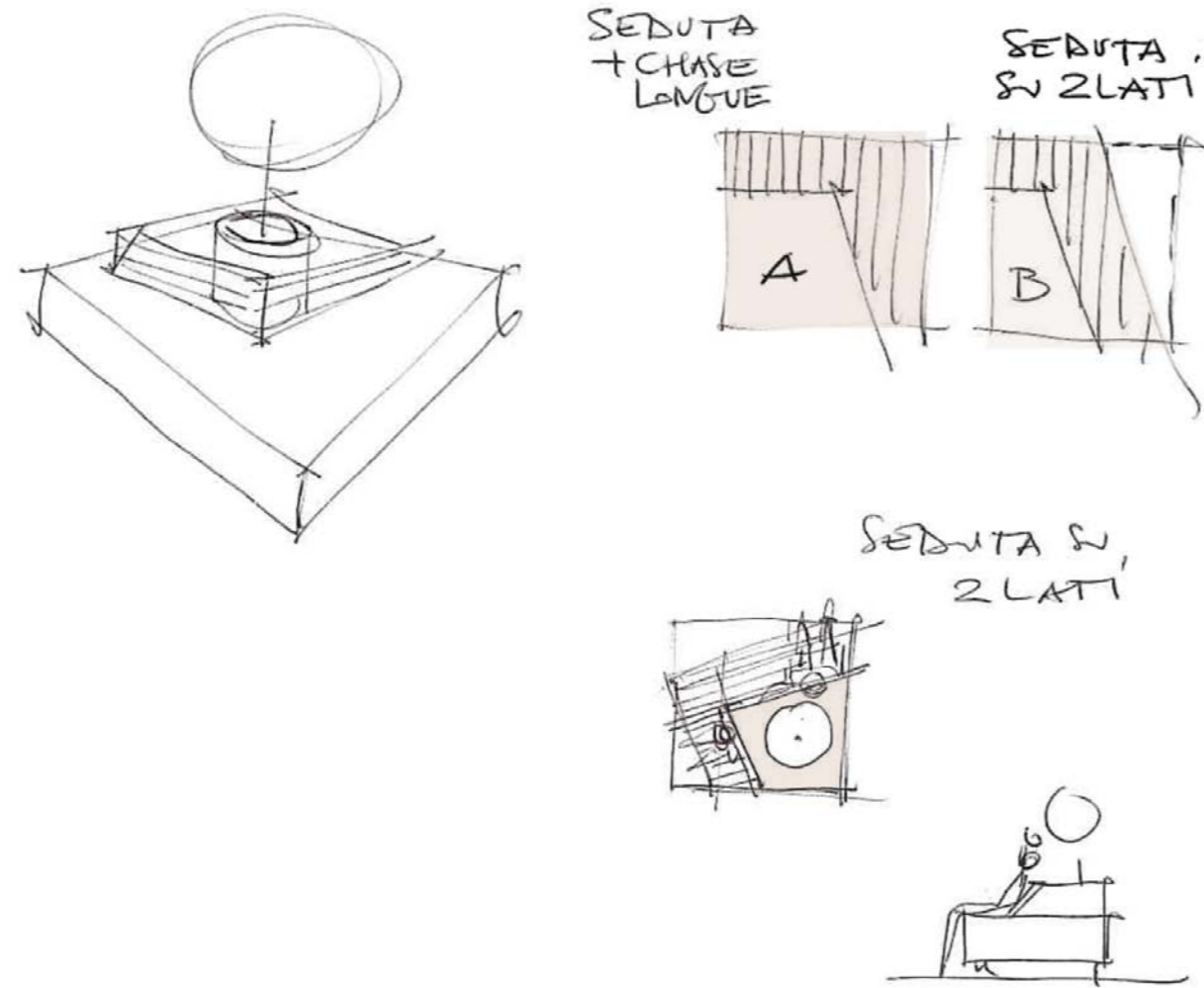

## A "GREEN" BENCH

For the restyling of Corso Fratelli Cervi, benches composed of two elements were studied: the basic seat/bench and the planter (which also works as a backrest for the seat).

The basic bench is square on the side with a "cut" that makes it trapezoidal. Both the classic seat and the "chaise longue" type seat were made with the same backrest.

The seat is made up of a hot-dip galvanized steel square tubular frame, complete with self-leveling bases and covered in wpc (technical wood) slats; the planter is made of completely smoothed and anti-graffiti treated high-performance concrete.







VASART®

PROJECT | MONTE ARGENTARIO

14

- Square project: Ing. Mario Bastreggi
- Urban furniture elements project for Vasart Urban Design: Antonio Lanzillo & Partners



## PORTO SANTO STEFANO

### PIAZZA DEI RIONI

To meet the specific needs of this intervention, we have designed 3 new products from the DIALOGO range:

The DIALOGO modular bench, created following the line between the garden and the square facing the sea.

The DIALOGO MAXI bench is a monoblock that weighs 3.200 kg!!!... in order not to be swept away by the waves of the tides.

The DIALOGO SMALL bench, made with a backrest in technical wood slats and electro-polished stainless steel brackets, with smaller dimensions so as not to invade the space of the promenade.

DIALOGO RANGE

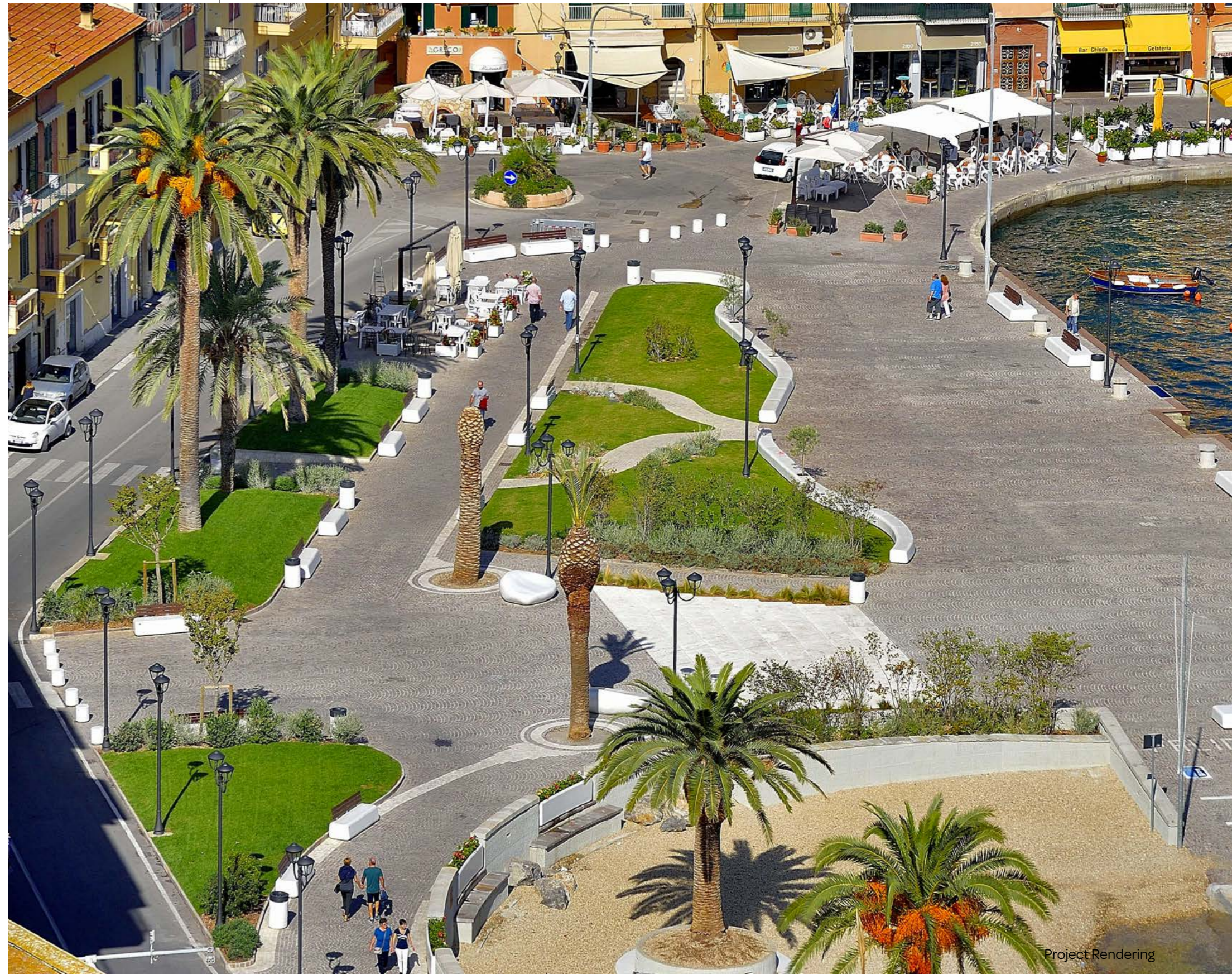



## MINIMALIST and timeless

The sinuous shapes of these benches are a hymn to a simple and minimalist yet refined design.



Project Rendering

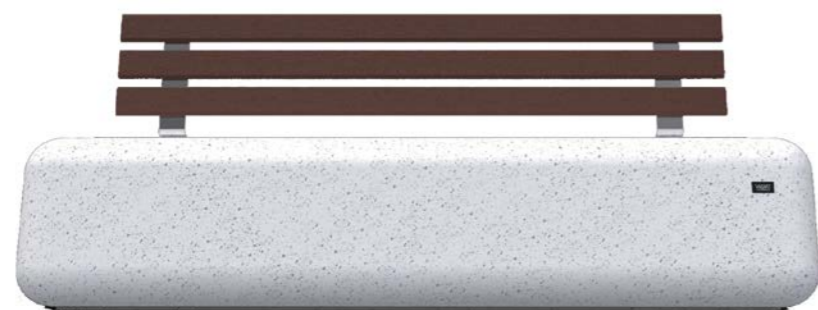

Project Rendering

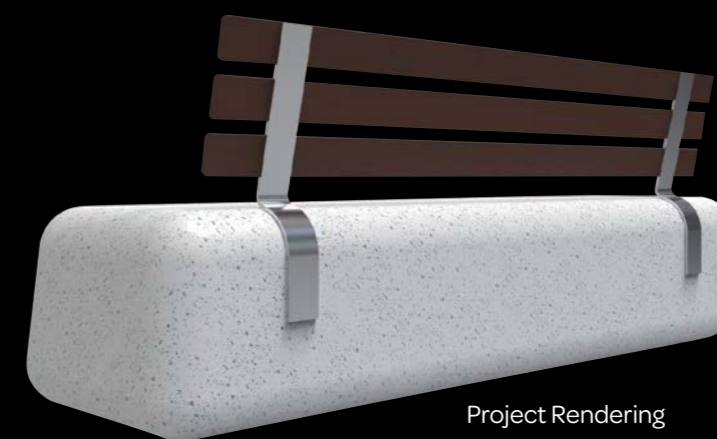
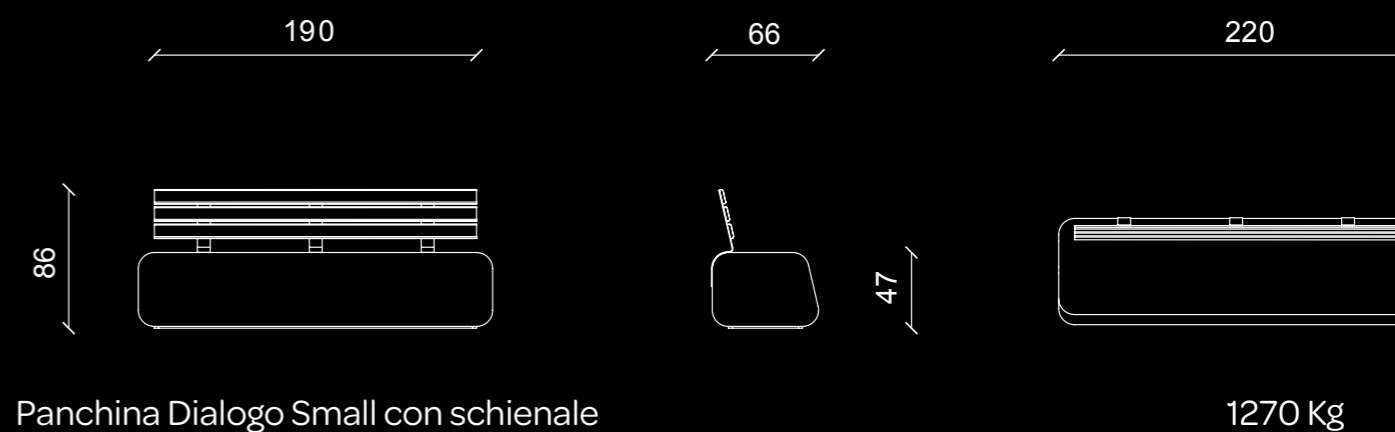
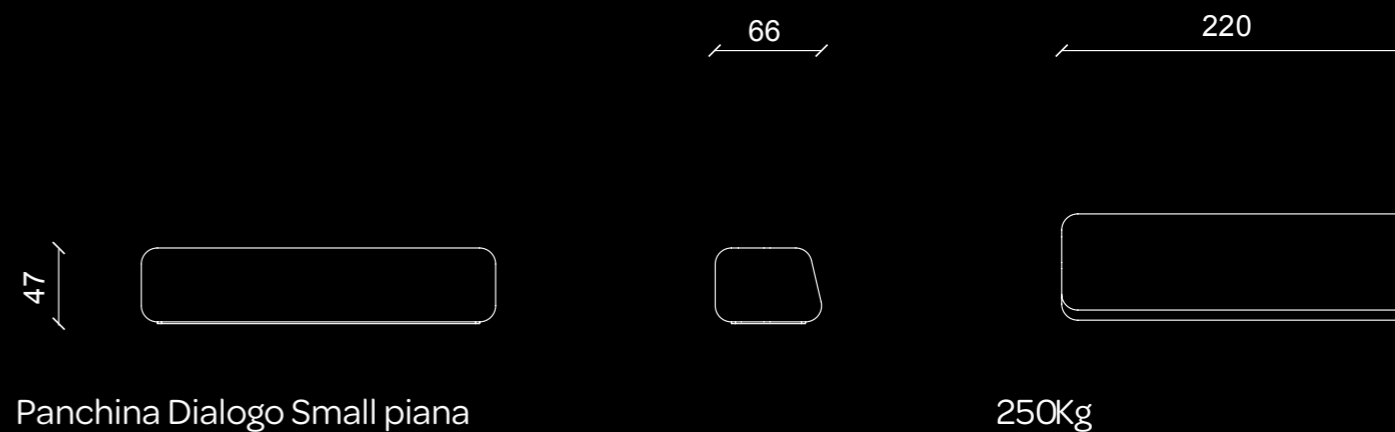

Project Rendering

## ELEGANT

anti-tip  
monoblocks

Anti-tip monoblocks made in High-performance concrete reinforced with knurled and galvanized steel; the surfaces are completely smoothed and treated with an anti-graffiti product. Equipped with backrest in engineered wood slats and electro-polished stainless steel brackets.





## SOFT LINES

of design

The style is characterized by very soft lines and a particular design. The surfaces are completely smoothed and treated with an anti-graffiti product. All edges are rounded with a 10 cm radius.

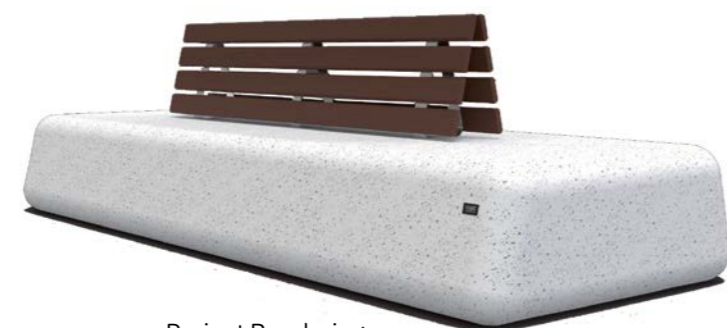

Project Rendering



Project Rendering

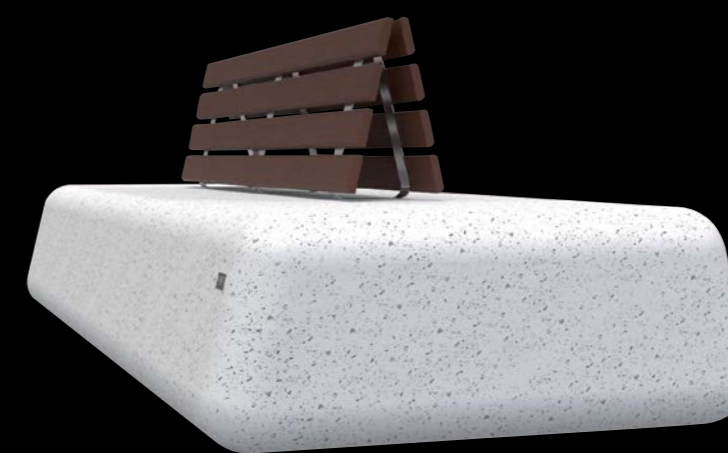
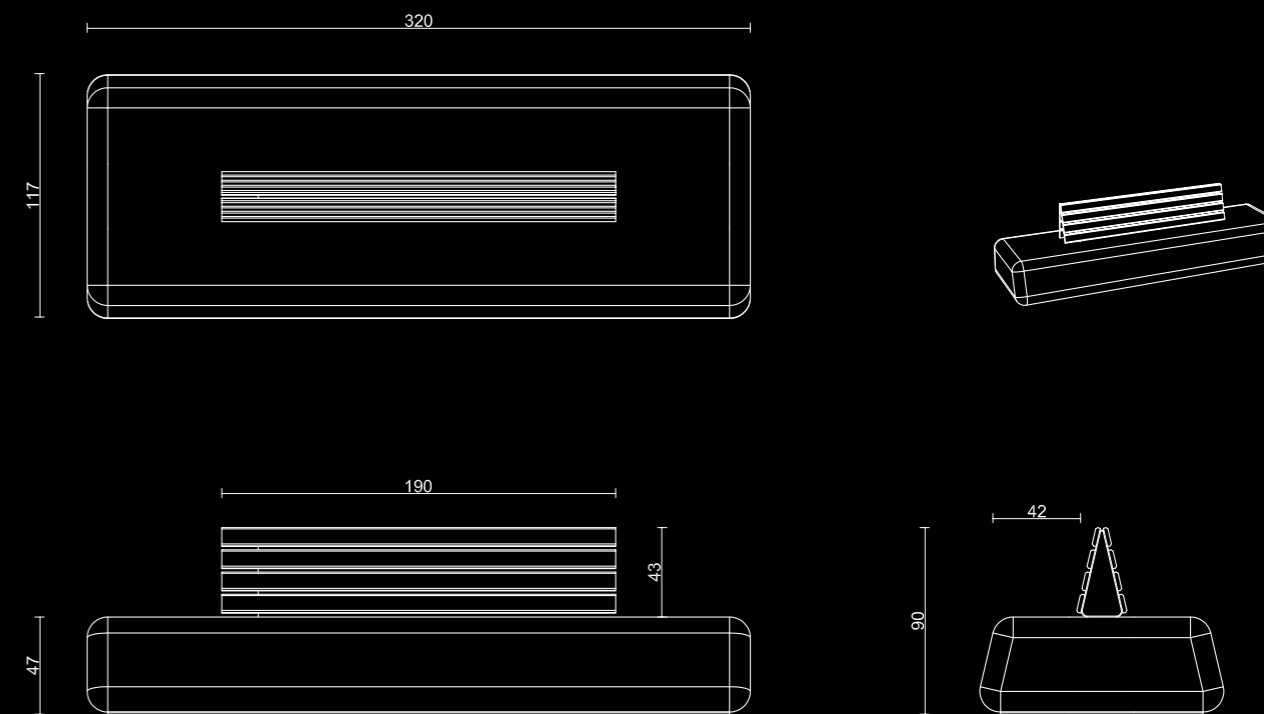

Project Rendering

## FURNISHING ELEMENTS

that last over time

Designing and creating an urban space also means inserting the furnishing elements in balance with the places and landscapes that surround them. The materials used must be resistant, versatile and long-lasting.







## LIGHT and materic



Designed by the wind of this place (the Nuvola planter was created to furnish the pier of "La Pilarella"). Safe protagonist of the urban space; Nuvola is inspired by a new architectural philosophy: revolutionary, unconventional and far from standard.

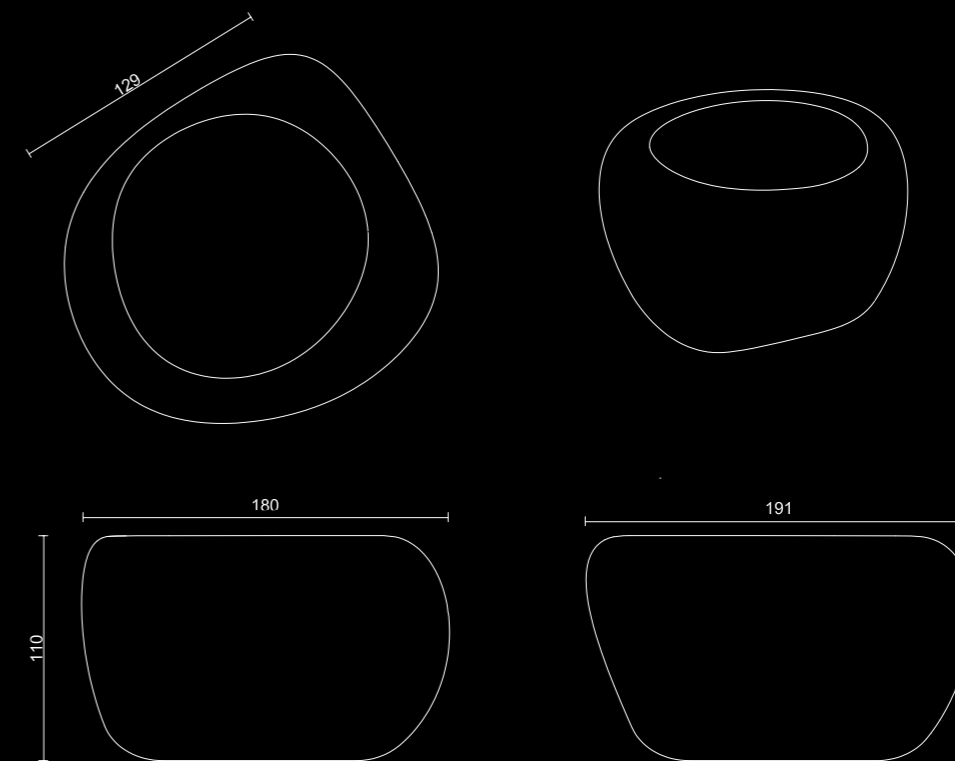

## "NUVOLA" BENCH

Monolithic, smoothed and clean: the hand-polished surface is treated with transparent antiscratch paints. Nuvola is a series of self-supporting planters in high-performance concrete.





## MONTE ARGENTARIO

PORTO ERCOLE

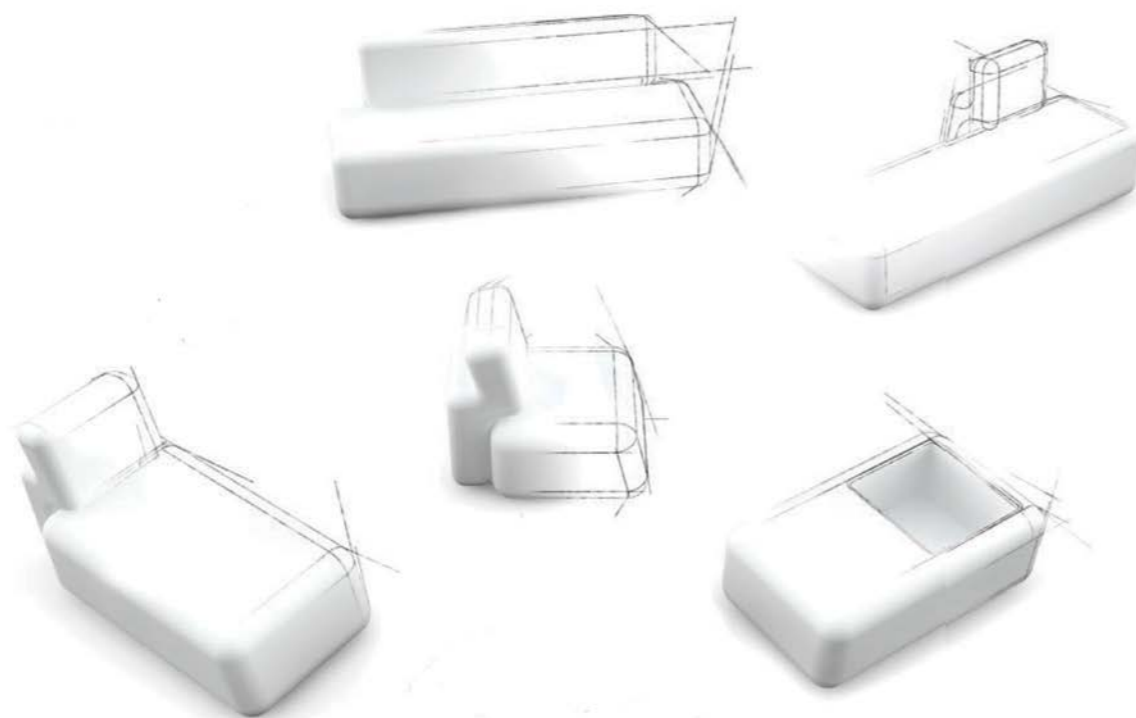

## DESIGNING

"urban living"

Think of the public space as a large and welcoming living room, to be furnished with style. Dialogo is the sofa while Incontro is the armchair.

A collection rich in elements, clean and elegant, to satisfy the needs of designers and follow the continuous evolution of cities.







## MONTE ARGENTARIO

### IL LUNGOMARE DEI NAVIGATORI

It was an honor and a privilege to furnish the wonderful Lungomare dei Navigatori, the pride of Porto Santo Stefano.

Designed by Giorgetto Giugiaro, it connects the two ports, the commercial one and the tourist one (Molo de La Pilarella) and leads to Piazza dei Rioni, today more than ever the true living room of Porto Santo Stefano.

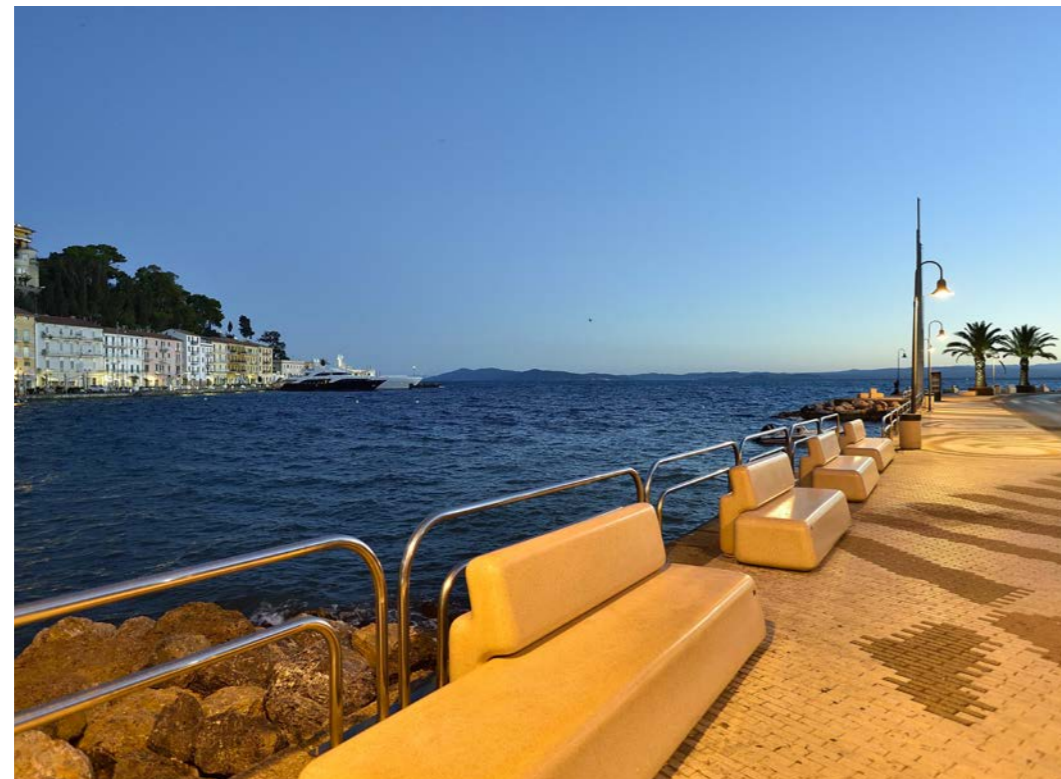





VASART®

**PROJECT | FALCONARA MARITTIMA**  
| LA CORTE | FRAZIONE CASTELFERRETTI

15

- Project: Arch. Gabriele Belardinelli  
 - Client: Pesaresi Giuseppe S.p.A.

## FALCONARA MARITTIMA

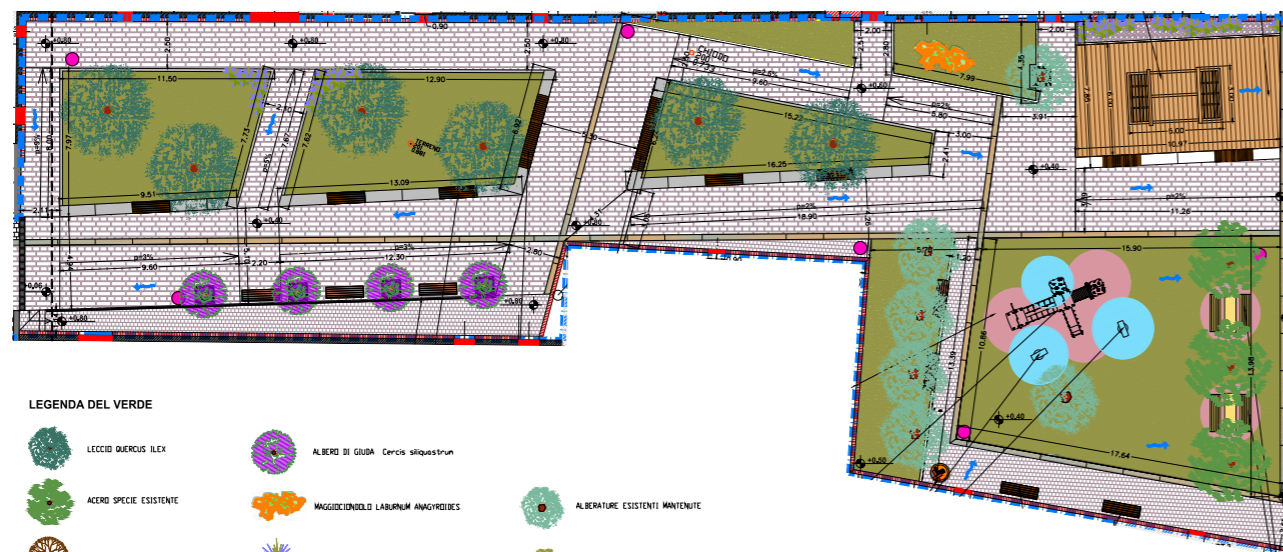

LEGENDA DEL VERDE

-  LECCIO QUERCUS ILEX
-  ACERO SPECIE ESISTENTE
-  ACERO ROSSO
-  ALBERO DI GIUDA Cercis siliquastrum
-  MAGGIORIBELLO LABURNUM ANGRICORUM
-  CESPUGLI DI LAVANDA
-  ALBERATURE ESISTENTI MANUTENUTE
-  ERBA TAPPETIZANTE COPRISOLELLO GIALLA

## THE PROJECT

The project includes the creation of benches that occupy the perimeter of the courtyard, to create meeting spaces and increase the existing green system. It is an innovative idea and tends to give a space back to the residents.



## “METROPOLITAN” BENCHES

Monobloc benches with clean and squared lines that give them a strong character and an essential presence, characterized by an interesting combination with the wooden seats with and without backrest.

# METROPOLITAN BENCHES

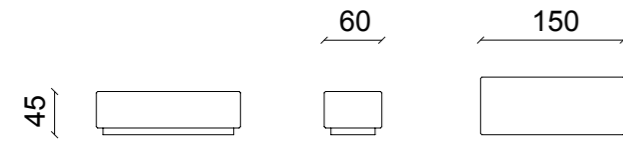

FLAT BENCHES 150

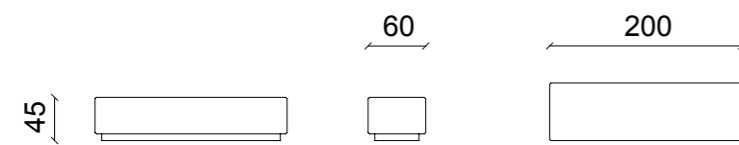

FLAT BENCHES 200

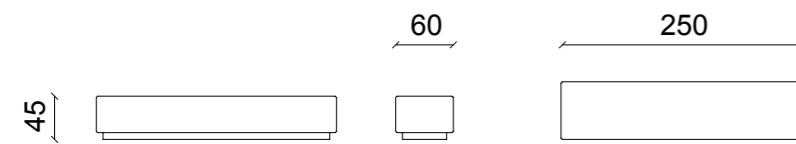

FLAT BENCHES 250

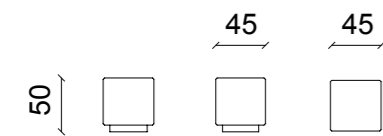

SINGLE SEAT





VASART®

**PROJECT | FIUMICINO**  
| LEONARDO DA VINCI AIRPORT |

16

- Client: ADR 

## FIUMICINO LEONARDO DA VINCI AIRPORT

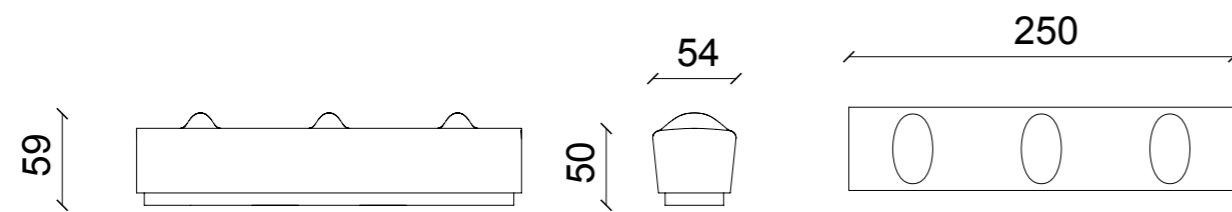
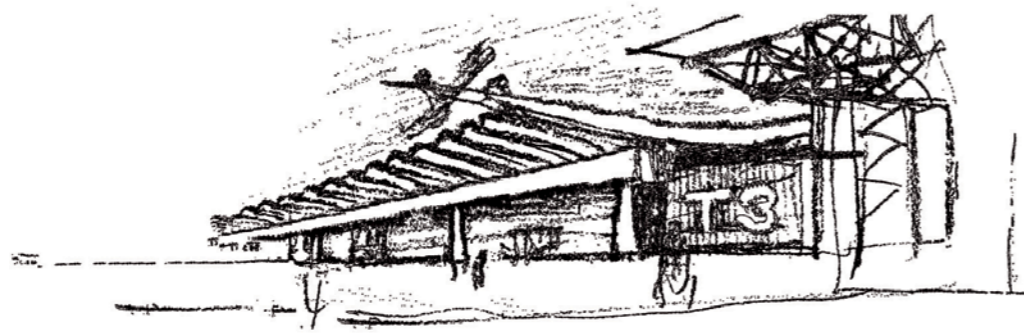

BENCHES WITH SEPARATORS

### THE PROJECT

The new DUNE bench can be used individually or side by side to create sessions of different lengths.

It is suitable for public environments with a high frequency of use and, as in this case, it can also be used as an anti-terrorism barrier.



“Fully sanded and anti-graffiti treated CLS HPC BENCHES”

The DUNE benches have rounded edges and tapered sides to ensure better seating comfort.

They can be made in two versions: one flat linear and one equipped with separating elements between the seats.

## DESIGNED FOR THE NEW TERMINAL

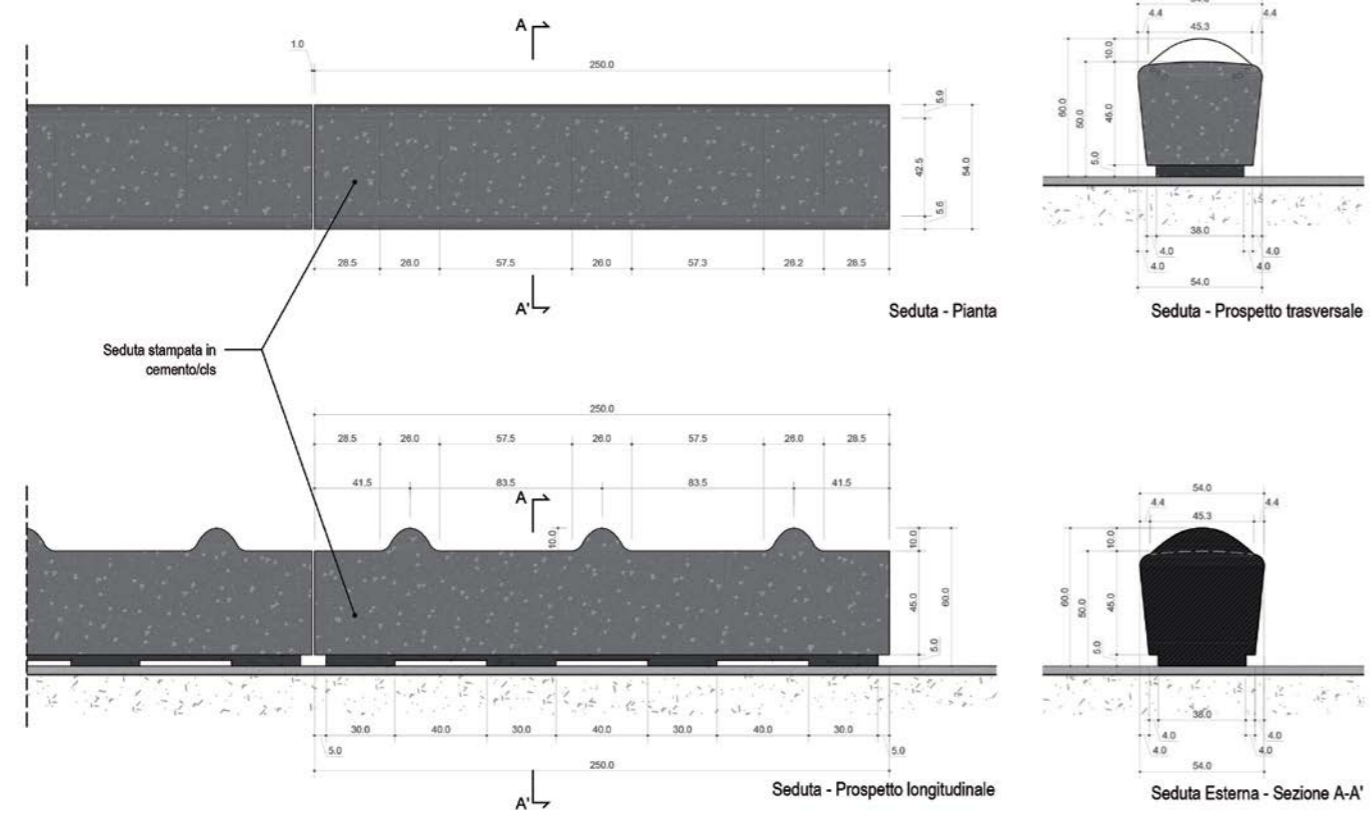

## DESIGN, functionality, safety

Designed to follow the continuous evolution of Fiumicino airport restyling, they integrate perfectly and find the right place in spaces where movement is constant and continuous.









VASART®

PROJECT | QATAR - DOHA

17

## DOHA

an ever-evolving city



### THE PROJECTS

Doha is an ever-evolving city, surprising in its progress of growth. Doha is an example of how a country that has been able to seize the opportunities offered by the modern world (Olympics, World Cup, Expo) can preserve its tradition and history without renouncing modernity and progress. Vasart Urban Design is proud to have created many furnishings for this new metropolis, where only the best products are carefully chosen.

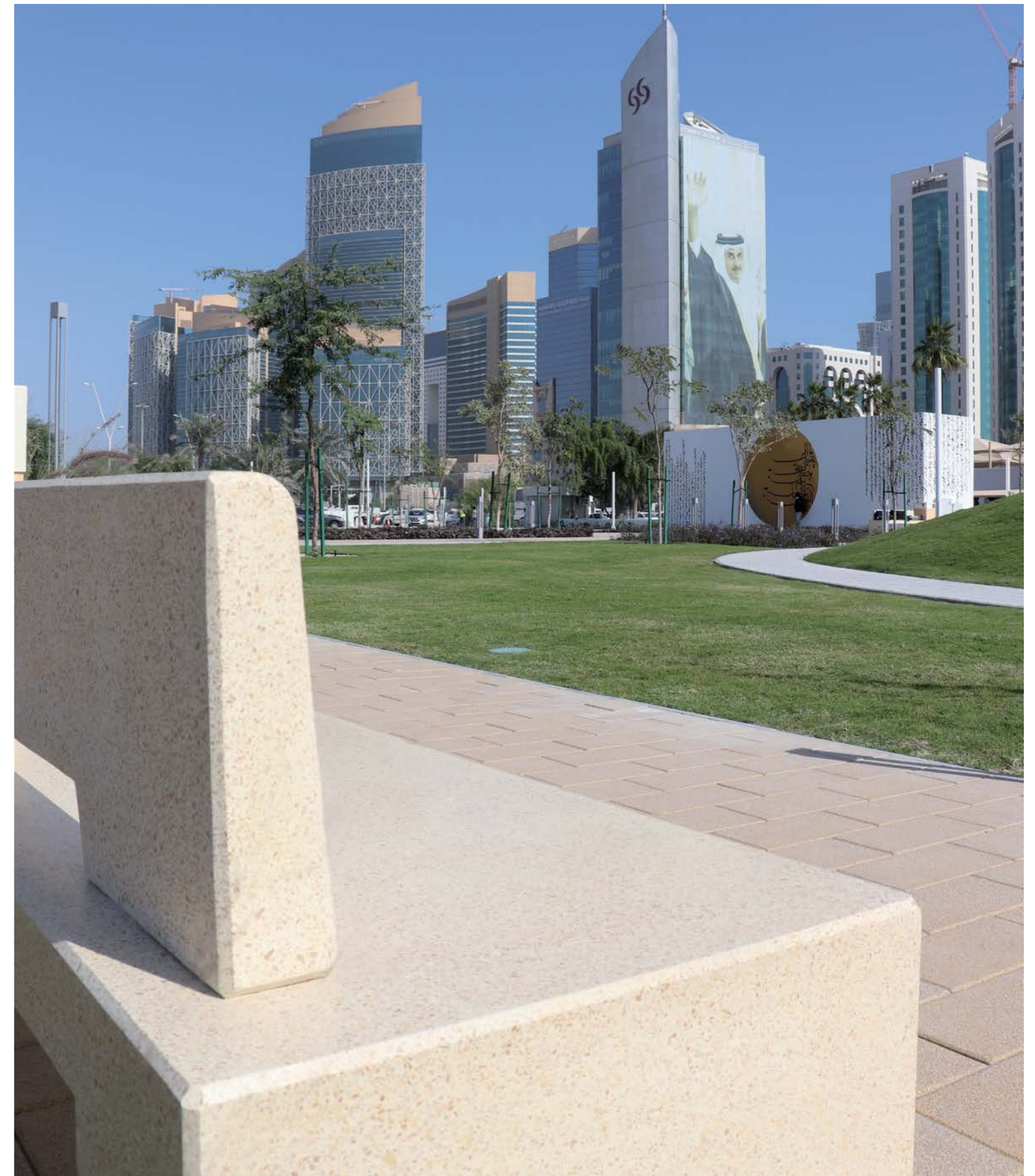







VASART®

**PROJECT | CIVITAVECCHIA**  
| TERRAZZA GUGLIELMI |

18



- Project: Ing. Iorio Giulio - Arch. Carboni Paola
- Public Works and Environment - Municipality of Civitavecchia

## CIVITAVECCHIA TERRAZZA GUGLIELMI

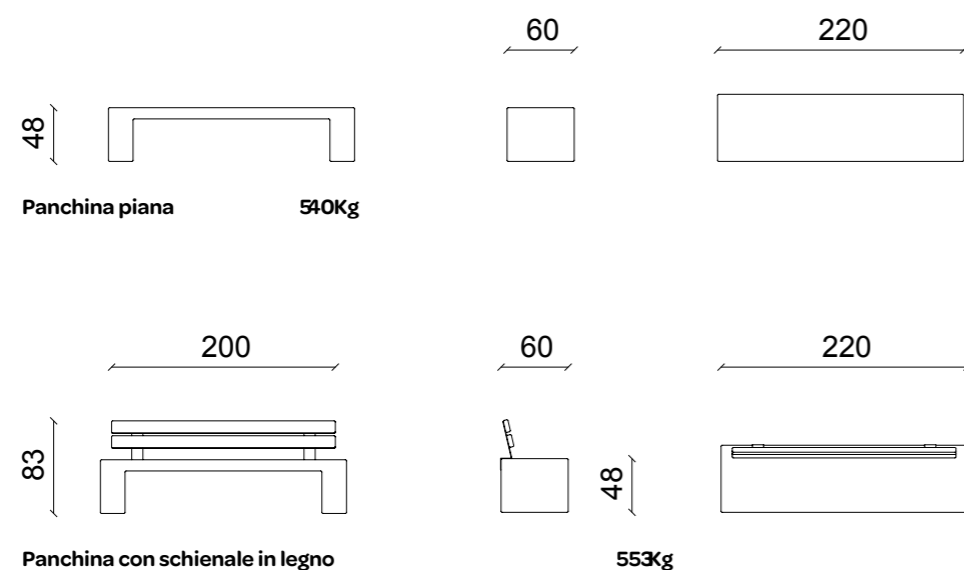

### THE PROJECT

Positioned on the Guglielmi terrace, next to the Michelangelo Fortress and on the Marina di Civitavecchia promenade, the STATION benches are made of smoothed VUD01 Carrara white high-performance concrete, some with exotic wood backrests and electropolished stainless steel brackets, others flat without backs.

A stop on the terrace allows you to admire the fortress up close, look towards the city center or turn your gaze to the sea...

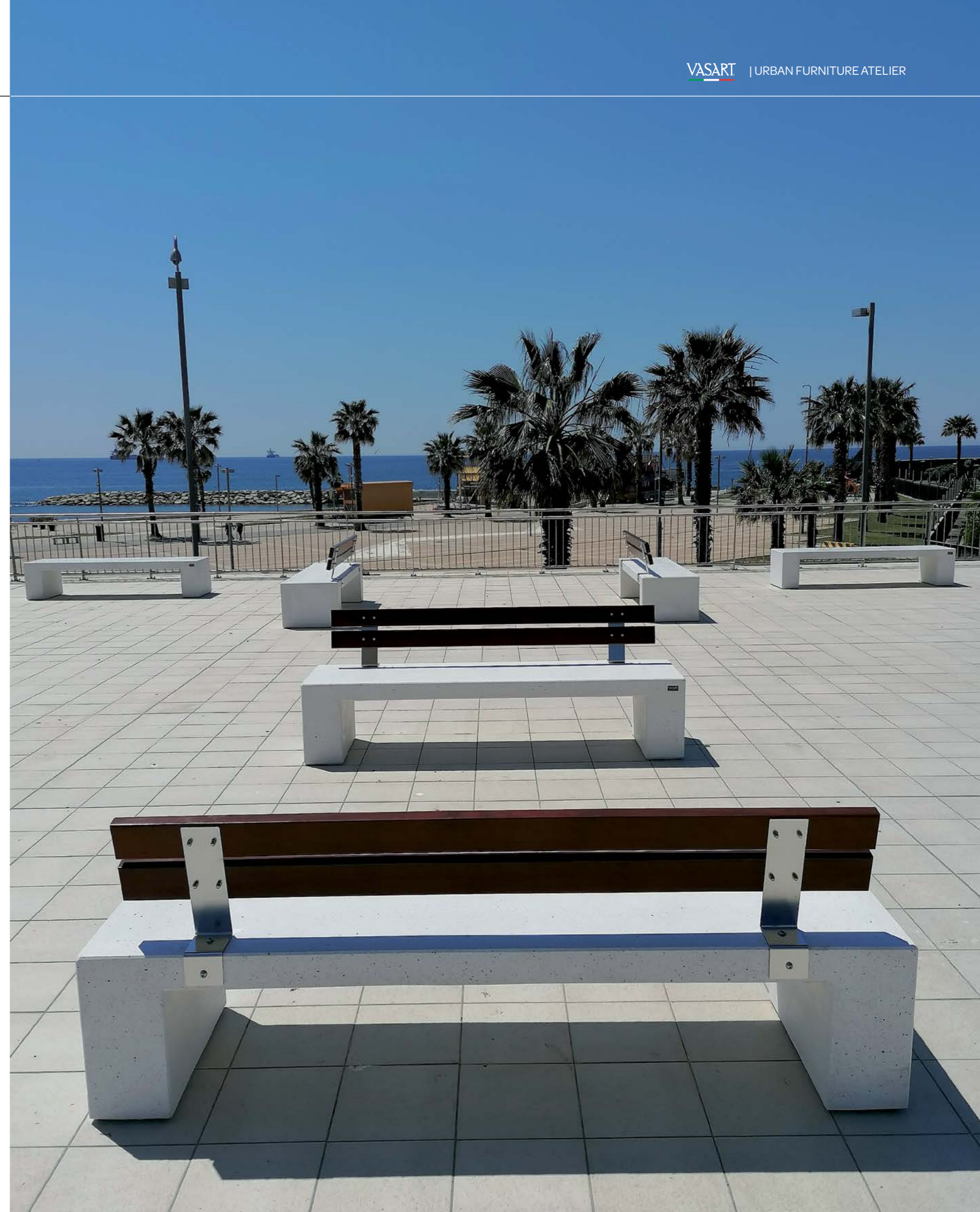



## A SILHOUETTE as a bench

Rigorous and with essential lines, in its unmistakable materiality, it recalls a silhouette.





VASART®

**PROJECT | POST PANDEMIC BENCH**  
| PARMA | PIAZZA GARIBALDI |

109

- Project: Post Pandemic Bench
- Place: Piazza Garibaldi, Parma
- Design: Associazione PANK-Ets - Francesca De Angelis, Alice Giroladini, Francesca Giannini
- Executive project: -ini studio, Francesca Giannini, Domenica Fiorini, Giulia Ghidini
- Photos: Barbara Rossi
- with the support of: Fondazione Cariparma and Lude

## POST PANDEMIC BENCH

[www.panchinapostpandemica.it](http://www.panchinapostpandemica.it)



## THE PROJECT

**Post Pandemic Bench is a temporary monument, conceived and designed to change over time.**

“How will it be possible to re-inhabit the city and allow citizens to re-encounter by reworking the pandemic together?” The Post Pandemic Bench installation was born from a long design process that started in March 2020 during the national lockdown, wanting to question the epochal change we were experiencing. The monument, made up of 10 modules and 8 trees, was conceived and designed to change over time and during the months of installation, the modules changed position together with the trees, representing three phases. Each of these phases represents a narration of the salient passages of the great changes that humanity has experienced during the pandemic. This continuous evolution has allowed citizens to experience the space of the square and the installation from unprecedented perspectives.

*Associazione PANK - ETS*

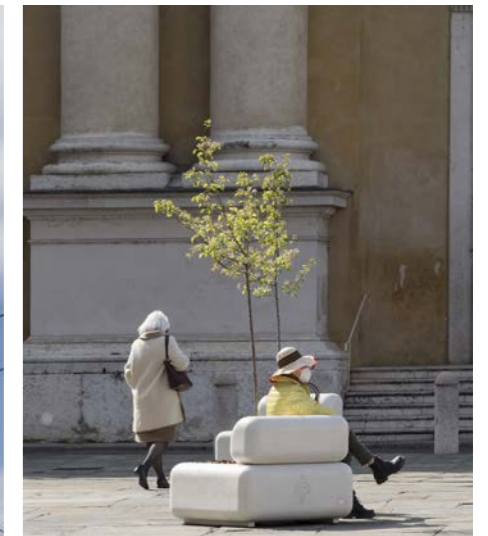



## BENCHES

THE BENCHES have the shape of a comfortable sofa and were made of completely smoothed and anti-graffiti treated VUD01 Carrara white high-performance concrete; in the first phase of the project they functioned as a planter, then they became benches with a comfortable seat made with wpc (technical wood) slats and finally they were brought together forming a “circle of aggregation” in the square... the long awaited END OF THE PANDEMIC.





# ABSTRACT

Openfabric and Vasart Urban Design collaboration

**Abstract is a blend that combines the precious and the banal.**

The white cement mixture contains fragments of various types of marble, as in the best tradition of the Venetian floor, historically considered elegant and refined. These precious materials are combined with glass fragments that add reflective power and transparency, making Abstract a reused material that combines the preciousness of the stones with the banality of commonly used objects.

Each fragment has specific characteristics, different geographical origins and a story to tell. Abstract becomes a mineral anthology, where every story tells an equally important point of view: from marble to shards of bottle.

The concept of “end of waste” indicates the transformation of a given material from waste into a resource, eliminating the traditional concept of waste and promoting its reusability. This approach is based on the idea of enhancing materials through recycling, recovery or other forms of recovery, in order to create a continuous cycle of use and reduce environmental impact.

The use of advanced technologies for waste treatment, the improvement of recycling processes and the identification of materials that can be transformed into resources are important aspects for promoting the end of waste.

Project:

## Openfabric

Oostkousdijk 12A,  
3024CM, Rotterdam NL  
[www.openfabric.eu](http://www.openfabric.eu)

Photos: Gaia Cambiaggi and Anna Positano (Studio Campo)





# BEYOND DESIGN

Vasart also creates standard elements with a modern and functional design, made to be inserted in any urban space.

Find our complete catalogue on our website products section



BENCHES — — — — —

PLANTERS — — — — —

PLANTERS WITH SEAT — — — — —

FOUNTAINS — — — — —

TREE GRATES — — — — —



— — — — — BUS SHELTERS

— — — — — BARRIERS

— — — PICNIC AREA

— — — BICYCLE RACKS

**VASART**

Reproduction, even partial, of the images and texts in this catalog is prohibited without the authorization of **VASART URBAN DESIGN s.r.l.**

Contributors to the creation of this catalogue:

**ART DIRECTION**

Andrea Gozzi

**GRAPHIC PROJECT**

Asterisko Comunicazione d'Eccellenza\_ [www.asterisko.org](http://www.asterisko.org)



# VASART®

ITALIAN URBAN DESIGN

Vasart Urban Design S.r.l.

Via G. di Vittorio 47/a  
42020 Puianello (RE) - Italy  
Tel: +39 0522885640  
info@vasart.it - [vasart.it/en/](http://vasart.it/en/)

